

STAR
VALVE



Hakkımızda

2012 yılında Kocaeli-Gebze'de kurulan STARVALVE Proses Vanaları ve Aktüatör Teknolojisi A.Ş., proses vanaları ve aktüatör sistemleri alanında uzmanlaşmış bir çözüm sağlayıcıdır. Sektördeki ihtiyaçlara uçtan uca çözümler sunmaktadır. 2020 yılında Dilovası'ndaki yeni tesisine taşınarak üretim kapasitesini artırmış, uluslararası pazarlarda daha güçlü bir konuma ulaşmıştır.

Ürün gamımızda;

- Teflon (PTFE/PFA) kaplı vanalar, boru ve ek parçaları,
- U-PVC, C-PVC, ABS, PP-H, PVDF gibi termoplastik malzemelerden üretilmiş vanalar, boru ve ek parçaları,
- Kelebek, küresel, bıçak sürgülü, diyafram vanalar gibi genel endüstriyel vanalar,
- Elektrik, pnömatik ve hidrolik aktüatörler yer almaktadır.

Ayrıca, Avrupa'nın önde gelen termoplastik vana üreticilerinden İtalyan FIP firmasının ve Hollanda merkezli endüstriyel vana üreticilerinden Como Valve B.V.'nin Türkiye'deki yetkili satıcısıyız.

Yenilikçi mühendislik yaklaşımımız, güçlü Ar-Ge ve üretim altyapımız, esnek stok yapımız ve müşteri odaklı çözümlerimizle; STARVALVE olarak müşterilerimizin değişen ihtiyaç ve taleplerine yenilikçi ve optimum çözümler üretiyor, her türlü akışkan kontrolü ihtiyacına profesyonel ve hızlı yanıt veriyoruz. Global pazarda güvenilir bir çözüm ortağı olma vizyonuyla ilerliyoruz.

About Us

Founded in 2012 in Kocaeli-Gebze, STARVALVE Proses Vanaları ve Aktüatör Teknolojisi A.Ş. is a solution provider specialized in industrial valves and actuator systems. We offer end-to-end solutions tailored to the needs of the industry. In 2020, we relocated to our new facility in Dilovası, expanding our production capacity and strengthening our position in international markets.

Our product range includes;

- Valves, pipes, and fittings lined with Teflon (PTFE/PFA)
- Valves, pipes, and fittings made from thermoplastic materials such as U-PVC, C-PVC, ABS, PP-H, and PVDF
- General industrial valves such as butterfly, ball, knife gate, and diaphragm valves
- Electric, pneumatic, and hydraulic actuators

We are also the authorized distributor in Türkiye for FIP, one of Europe's leading thermoplastic valve manufacturers, and Como Valve B.V., a Dutch industrial valve producer.

With our innovative engineering approach, strong R&D and production infrastructure, flexible inventory system, and customer-focused solutions, STARVALVE develops innovative and optimal responses to the evolving needs and demands of its customers. We provide fast and professional solutions to all fluid control requirements and continue to move forward with the vision of becoming a trusted solution partner in the global market.

METAL VALVES

- SV325 Series, Manual, Wafer Type Butterfly Valves
- SV325 Series, Pneumatic Actuated, Wafer Type Butterfly Valves
- SV325 Series, Electrical Actuated, Wafer Type Butterfly Valves
- SV335 Series, Manual, Pneumatic Actuated, Electrical Actuated, Lug Butterfly Valves
- SV370 Series, Wafer Type Double Eccentric High Performance Butterfly Valves
- SV371 Series, Lug Type Double Eccentric High Performance Butterfly Valves
- SV390 Series, Wafer Type Triple Eccentric High Performance Butterfly Valves
- SV340 Series, Hygienic Butterfly Valves
- SV222 Series, Lever, Pneumatic Actuated, Electrical Actuated, Two Pieces Threaded End Ball Valves
- SV223 Series, Lever, Pneumatic Actuated, Electrical Actuated, Three Pieces Threaded End Ball Valves
- SV224 Series, Lever, Pneumatic Actuated, Electrical Actuated, Monoblock Type Ball Valves
- SV225 Series, Lever, Pneumatic Actuated, Electrical Actuated, Two Pieces Flanged Ball Valves
- SV226 Series, Lever, Pneumatic Actuated, Electrical Actuated, Three Pieces Flanged Ball Valves
- SV230 Series, Lever, Pneumatic Actuated, Electrical Actuated, Three - Way Ball Valves
- SV671 Series, Dual Plate Check Valves
- SV956 Series, Slurry Type Knife Gate Valves
- Other Type, Knife Gate Valves
- SV228/ SV229 Series, V-Port Segment Ball Valves
- SV971 Series, Manual, Pneumatic Actuated Pinch Valves



CONTENT

TEFLON LINED PRODUCTS

- SV350 Series, PTFE (Teflon) Lined Butterfly Valves
- SV460 Series, PFA (Teflon) Lined Diaphragm Valves
- SV261 Series, PFA (Teflon) Lined Plug Valves
- SV250 Series, PFA (Teflon) Lined Ball Valves
- SV656 - SV650 Series, PFA (Teflon) Lined Check Valves
- SV910P Series, PFA/PTFE (Teflon) Expansion Joint
- SV930P Series, PFA/PTFE (Teflon) Lined Pipe and Fittings





SV210 Series, Double Union, Industrial Type Ball Valves
SV210 Series, Pneumatic Actuated, Industrial Type Ball Valves
SV210 Series, Electrical Actuated, Industrial Type Ball Valves
SV231 Series, Double Union, Industrial Type Three-Way Ball Valves
SV231 Series, Pneumatic Actuated, Industrial Type Three-Way Ball Valves
SV231 Series, Electrical Actuated, Industrial Type Three-Way Ball Valves
SV120 (FE) Series, Hand Lever, Economical Type Butterfly Valves
SV120 (FE) Series, Pneumatic Actuated, Economical Type Butterfly Valves
SV120 (FE) Series, Electrical Actuated, Economical Type Butterfly Valves
SV120 (FK) Series, Manual, Industrial Type Butterfly Valves
SV120 (FK) Series, Pneumatic Actuated, Industrial Type Butterfly Valve
SV120 (FK) Series, Electrical Actuated, Industrial Type Butterfly Valves
DK Series, Industrial Type Diaphragm Valves
VM Series, Industrial Type Diaphragm Valves
DK Series, Pneumatic Actuated Diaphragm Valves
SV420 Series, Pressure Control Valves
SV610 Series, Double Union, Industrial Type Ball Check Valves
SV620 Series, Industrial Type, Swing Check Valves
SV630 Series, Single Union, Industrial Type Foot Valves
CR / FR Series, Wafer Type Swing Check Valves
RV Series, Y-Type Strainers
S12 / S22 Series, 2/2 Way Solenoid Valves
SV930T Series, U-PVC Pipe and Fittings
SV930T Series, PP-H Pipe and Fittings
SV930T Series, PVDF Pipe and Fittings
SV930T Series, C-PVC Pipe and Fittings
SV930T Series, Clear-PVC Pipe and Fittings
SV930T Series, ABS Pipe and Fittings

THERMOPLASTIC PRODUCTS

CONTENT



SV362 Double Eccentric Double Flanged End Butterfly Valves
SV952 Flanged Gate Valves
SV680 Air Release Valves
SV667 Flanged End Swing Check Valve
SV660 Threaded, Flanged End Ball Check Valve
SV720 Flanged End Y Type Stainer
SV931D Dismantling Joint

WATERWORKS GROUP



STAR-P Series, Aluminum Body Pneumatic Actuators
STAR-PP Series, Polyamide Body Pneumatic Actuators
STAR-PS Series, Stainless Steel Body Pneumatic Actuators
Pneumatic Actuator Accessories
STAR-ALFA Series, Quarter Turn Electric Actuators
STAR-ALFA10 Series, Electric Actuators
STAR-E Series, Quarter Turn Electric Actuators
STAR-EV Series, Quarter Turn Electric Actuators With Manual Override
STAR-M Series, Electric Actuators

ACTUATORS



SV810 Series, Variable Area Flowmeters
SV815 Series, Diaphragm Type Pressure Gauge
SV819 Series, Pulsation Dampeners

MEASURING



METAL VALVES

SV325 SERIES

MANUAL WAFER TYPE BUTTERFLY VALVES

TECHNICAL ADVANTAGES

- 1" - 48" (DN25 - DN1200) size options,
- According to type of fluid wide seat options (EPDM, Viton, Silicone, NBR, SBR),
- According to type of fluid wide disc options (AISI316, Duplex, Super Duplex, Alu-Bronze, Rilsan Coated GGG40 Ductile Iron),
- -20 °C - 204 °C working temperature option,
- ISO5211 according to directly assembled actuators top flanged,
- Lower open/close torque,
- Manual , Pneumatic Actuated and Electrical Actuated control options,
- PN 10 / PN 16 / PN 25 working pressure,
- 100% tightness testing before shipment,
- DIN, ANSI, JIS norms



Application with traceable limit switch box



APPLICATION AREA

- Chemical and Petrochemical Industry,
- Water and Process Technologies,
- In the Shipbuilding and Yacht Industry,
- Mining Industry,
- Food Industry,
- HVAC

- **Design Standards**
EN593 Series 20,
EN 1092,
API609 Table 1,
BS5155 Series 4
ISO5211

- **Face to Face**
DIN558-1,
API609,
DIN3202,
ISO5752,
BS5155

- **Flange Standards**
DIN2501 PN6/PN10/PN16,
ANSI B16.15 Class150

- **Leakage Class**
ISO05208 Category 3,
API 598 Table 5,
EN12266-1,
Class-6

DESIGN STANDARDS

TECHNICAL ADVANTAGES

- 1" - 48" (DN25 - DN1200) size options,
- According to type of fluid wide seat options (EPDM, Viton, Silicone, NBR, SBR),
- According to type of fluid wide disc options (AISI316, Duplex, Super Duplex, Alu-Bronze, Rilsan Coated GGG40 Ductile Iron),
- -20 °C ~ 204 °C working temperature option,
- ISO5211 according to directly assembled actuators top flanged,
- Lower open/close torque,
- Manual , Pneumatic Actuated and Electrical Actuated control options,
- PN 10 / PN 16 / PN 25 working pressure,
- 100% tightness testing before shipment,
- DIN, ANSI, JIS norms

SV325 SERIES

PNEUMATIC ACTUATED WAFER TYPE BUTTERFLY VALVES



ACTUATOR FEATURES

- Aluminum extruded body,
- Double acting or single acting (spring return) pneumatic actuator options,
- Optional on / off switch box with mechanical or proximity limit,
- NAMUR type air valve options,
- 3-15 psi, 4-20mA input, 4-20mA input/output proportional control

DESIGN STANDARDS

- **Design Standards**
EN593 Series 20, EN 1092, API609 Table 1, BS5155 Series 4 ISO5211

- **Face to Face**
DIN558-1, API609, DIN3202, ISO5752, BS5155

- **Flange Standards**
DIN2501 PN6/PN10/PN16, ANSI B16.15 Class150

- **Leakage Class**
ISO05208Category 3, API 598 Table 5, EN12266-1, Class-6

SV325 SERIES

ELECTRICAL ACTUATED WAFER TYPE BUTTERFLY VALVES

TECHNICAL ADVANTAGES

- 1" - 48" (DN25 - DN1200) size options,
- According to type of fluid wide seat options (EPDM, Viton, Silicone, NBR, SBR),
- According to type of fluid wide disc options (AISI316, Duplex, Super Duplex, Alu-Bronze, Rilsan Coated GGG40 Ductile Iron),
- -20 °C ~ 204 °C working temperature option,
- ISO5211 according to directly assembled actuators top flanged,
- Lower open/close torque,
- Manual , Pneumatic Actuated and Electrical Actuated control options,
- PN 10 / PN 16 / PN 25 working pressure,
- 100% tightness testing before shipment,
- DIN, ANSI, JIS norms



ACTUATOR FEATURES

- 24V DC, 24V AC/DC, 220V AC, 110V AC power supply options,
- Proportional control with a choice of 4-20 mA,
- Manual override option in case of power failure

- **Design Standards**
EN593 Series 20,
EN 1092,
API609 Table 1,
BS5155 Series 4
ISO5211

- **Face to Face**
DIN558-1,
API609,
DIN3202,
ISO5752,
BS5155

- **Flange Standards**
DIN2501 PN6/PN10/PN16,
ANSI B16.15 Class150

- **Leakage Class**
ISO05208 Category 3,
API 598 Table 5,
EN12266-1,
Class-6

DESIGN STANDARDS

TECHNICAL ADVANTAGES

- 1½" ~ 48" [DN40 ~ DN1200] Size Options,
- Specially designed with rigid construction for heavy industrial applications,
- According to type of fluid wide seat options (EPDM, Viton, Silicone, NBR, Neoprene (CR), Hypalon, SBR),
- According to type of fluid wide disc options (AISI316, Duplex, Super Duplex, Alu-Bronze, Rilsan Coated GGG40 Ductile Iron),
- -20°C ~ 204°C working temperature option,
- ISO5211 according to directly assembled actuators top flanged,
- Lower open/close torque,
- PN 10 / PN 16 / PN 25 working pressure,
- 100% tightness testing before shipment,
- DIN, ANSI, JIS norms

SV335 SERIES

MANUAL/ PNEUMATIC ACTUATED/ ELECTRICAL ACTUATED LUG TYPE BUTTERFLY VALVES



APPLICATION AREA

- Chemical and Petrochemical Industry,
- Water and Process Technologies,
- In the Shipbuilding and Yacht Industry,
- Mining Industry,
- Food Industry,
- Heating-Cooling System

• **Design Standards**
EN 558 Series 20
(DIN 3202 T3 K1),
ISO 5752 Series 20,
API 609 Table 1,
BC 5155 Series 4

• **Top Flange Standard**
ISO5211

• **Flange Standards**
DIN 2501 PN/PN10/PN16, ISO5208,
ANSI B 16.15 Class 150,
AWWA C207,
JIS B 2211-5K,
JIS B 2212-10K

• **Pressure Difference**
PN 10 / PN 16 / PN 25

• **Sealing Standards**
DIN 2501 PN/PN10/PN16, ISO5208,
Category-3,
API 598 Table-5,
ANSI B 16-104,
Class-6

• **Operating Pressure**
PN 10 / PN 16 / PN 25

• **Vacuum**
0.2 Bar Absolute
Pressure

• **Ex-proof Class**
ATEX 94/9 EC Group II,
Category 2 GD

• **ABS Certification**
ABS 1-1-7/7, 4-62-/5.11

DESIGN STANDARDS

SV370 SERIES

WAFER TYPE DOUBLE ECCENTRIC HIGH PERFORMANCE BUTTERFLY VALVES

TECHNICAL ADVANTAGES

- 2" ~ 48" (DN50 ~ DN1200) Size Options ,
- Specially designed with rigid construction for heavy industrial applications,
- Soft Seat (-29 °C ~ 210 °C) , Fire Safe Seat (-29 °C ~ 210 °C) , Metal Seat (-29 °C ~ 500 °C) Options,
- ISO5211 according to directly assembled actuators top flanged,
- DIN, ANSI, JIS norms
- Max. PN100 Pressure Class



ACTUATOR FEATURES

Pneumatic Actuator

- Aluminum extruded body,
- Double acting or single acting (spring return) pneumatic actuator options,
- Optional on / off switch box with mechanical or proximity limit,
- NAMUR type air valve options,
- 3-15 psi, 4-20mA input, 4-20mA input/output proportional control

Electrical Actuator

- 24V DC, 24V AC/DC, 220V AC, 110V AC power supply options,
- Proportional control with a choice of 4-20 mA,
- Manual override option in case of power failure

DESIGN STANDARDS

- **Design Standards**
EN 558 Series 20 (DIN 3202 T3 K1), ISO 5752 Series 20, API 609 Table 1, BC 5155 Series 4

- **Flange Standards**
DIN 2501 PN16/25/40/100, JIS B 2211-5K, JIS B 2212- 10K

- **Face to Face**
API609 A, ISO 5752

- **Inspection and Testing**
ISO 5208, API 598, MSS SP-61, MSS SP-68

- **Fire Safe**
API 607

- **Leakage Class**
API 598, EN12266, ISO5208 Category-3, ANSI FCI 70-2-2023 Table1 Class VI,IV MSS SP-61 MSS SP-68

TECHNICAL ADVANTAGES

- 2" ~ 48" (DN50 ~ DN1200) Size Options ,
- Specially designed with rigid construction for heavy industrial applications,
- Soft Seat (-29 °C ~ 210 °C) , Fire Safe Seat (-29 °C ~ 210 °C) , Metal Seat (-29 °C ~ 500 °C) Options,
- ISO5211 according to directly assembled actuators top flanged,
- DIN, ANSI, JIS norms,
- Max. PN100 Pressure Class

SV371 SERIES

LUG TYPE DOUBLE ECCENTRIC HIGH PERFORMANCE BUTTERFLY VALVES



ACTUATOR FEATURES

Pneumatic Actuator

- Aluminum extruded body,
- Double acting or single acting (spring return) pneumatic actuator options,
- Optional on / off switch box with mechanical or proximity limit,
- NAMUR type air valve options,
- 3-15 psi, 4-20mA input, 4-20mA input/output proportional control

Electrical Actuator

- 24V DC, 24V AC/DC, 220V AC, 110V AC power supply options,
- Proportional control with a choice of 4-20 mA,
- Manual override option in case of power failure

DESIGN STANDARDS

- **Design Standards**
EN 558 Series 20 (DIN 3202 T3 K1), ISO 5752 Series 20, API 609 Table 1, BC 5155 Series 4

- **Face to Face**
API 609 A, ISO 5752

- **Flange Standards**
DIN 2501
PN16/25/40/100, JIS B 2211-5K, JIS B 2212- 10K

- **Inspection and Testing**
ISO 5208, API 598, MSS SP-61, MSS SP-68

- **Fire Safe**
API 607

- **Leakage Class**
API 598, EN12266, ISO5208 Category-3, ANSI FCI 70-2-2023 Table1 Class VI,IV MSS SP-61 MSS SP-68

SV390 SERIES

WAFER TYPE TRIPLE ECCENTRIC HIGH PERFORMANCE BUTTERFLY VALVES

TECHNICAL ADVANTAGES

- 2" ~ 48" (DN50 ~ DN1200) Size Options ,
- Specially designed with rigid construction for heavy industrial applications,
- Soft Seat (-45 °C ~ +435 °C)
- ISO5211 according to directly assembled actuators top flanged,
- DIN, ANSI, JIS norms



ACTUATOR FEATURES

Pneumatic Actuator

- Aluminum extruded body,
- Double acting or single acting (spring return) pneumatic actuator options,
- Optional on / off switch box with mechanical or proximity limit,
- Optional with NAMUR valve type air direction,
- 3-15 psi or proportional control with a choice of 4-20 mA

Electrical Actuator

- 24V DC, 24V AC/DC, 220V AC 110V AC power supply options,
- Proportional control with a choice of 4-20 mA,
- Manual override option in case of power failure

DESIGN STANDARDS

- **Design Standards**
ASME V16.34

- **Flange Standards**
DIN 2501
PN16/PN25/PN40/
PN100/PN160

- **Leakage Class**
ANSI FCI 70-2-2023
Table1
ISO 5208 Rte D/A

- **Face to Face**
API609 A,
ISO 5752

- **Fire Safe**
API 607,
ISO 10497

- **Inspection and Testing**
ISO 5208,
API 598

TECHNICAL ADVANTAGES

- ½" ~ 10" sizes,
- Smooth inner surface,
- Easy adaptability to different processes thanks to their modular structure,
- Low flow resistance,
- Manual or actuated control options,
- Quick and easy maintenance

SV340 SERIES

HYGIENIC BUTTERFLY VALVES



CONNECTION TYPE

- Butt Welded
- Tri-Clamp Fittings

ACTUATOR FEATURES

- On/Off and Proportional Electrical Actuator (24V DC, 24V AC/DC, 220V AC, 110V AC) power supply options,
- On/Off and Proportional Pneumatic Actuator (Double and Single Acting),
- Lever and Gearbox

APPLICATION AREA

- Food and Beverage Industry,
- Dairy Products Industry,
- Pharmaceutical and Biotechnology Industry,
- Chemical Industry (High Purity Applications),
- Water Treatment

SV222 SERIES

LEVER / PNEUMATIC ACTUATED / ELECTRICAL ACTUATED TWO PCS THREADED END BALL VALVES

TECHNICAL ADVANTAGES

- ½" ~ 4" sizes,
- ISO5211 according to directly assembled actuators top flanged,
- Friction and wearing – resistance PTFE (teflon) ball seat,
- 100% tightness testing before shipment



MATERIAL OPTIONS

- AISI304 Stainless Steel,
- AISI316 Stainless Steel,
- A216 WCB Carbon Steel

CONNECTION TYPE

- Threaded End,

ACTUATOR FEATURES

Pneumatic Actuator

- Aluminum extruded body,
- Double acting or single acting (spring return) pneumatic actuator options,
- Optional on / off switch box with mechanical or proximity limit,
- NAMUR type air valve options,
- 3-15 psi, 4-20mA input, 4-20mA input/output proportional control

Electrical Actuator

- 24V DC, 24V AC/DC, 220V AC, 110V AC power supply options,
- Proportional control with a choice of 4-20 mA,
- Manual override option in case of power failure

TECHNICAL ADVANTAGES

- 1/4" ~ 4" sizes,
- Anti-static ball shaft and body design,
- Three pieces body provides easily assembly,
- ISO5211 according to directly assembled actuators top flanged,
- DIN3202-M3 Norms,
- Friction and wearing resistance PTFE (Teflon) ball seal,
- 100% tightness testing before shipment,
- DIN, ANSI, JIS Norms

SV223 SERIES LEVER / PNEUMATIC ACTUATED / ELECTRICAL ACTUATED THREE PIECES THREADED END BALL VALVES



MATERIAL OPTIONS

- AISI304 Stainless Steel,
- AISI316 Stainless Steel,
- A216 WCB Carbon Steel,
- Super Duplex

CONNECTION TYPE

- Threaded End,
- Butt Welded,
- Socket Welded

ACTUATOR FEATURES

Pneumatic Actuator

- Aluminum extruded body,
- Double acting or single acting (spring return) pneumatic actuator options,
- Optional on / off switch box with mechanical or proximity limit,
- NAMUR type air valve options,
- 3-15 psi, 4-20mA input, 4-20mA input/output proportional control

Electrical Actuator

- 24V DC, 24V AC/DC, 220V AC, 110V AC power supply options,
- Proportional control with a choice of 4-20 mA,
- Manual override option in case of power failure

SV224 SERIES

LEVER / PNEUMATIC ACTUATED / ELECTRICAL ACTUATED MONOBLOCK TYPE BALL VALVES

TECHNICAL ADVANTAGES

- DN15 ~ DN250 sizes,
- Anti-static ball shaft and body design,
- One -piece body takes up less space,
- ISO5211 direct mounting actuator mount pad,
- Friction and wearing resistance PTFE (Teflon) ball seal,
- 100% tightness test before shipment,
- DIN, ANSI norms

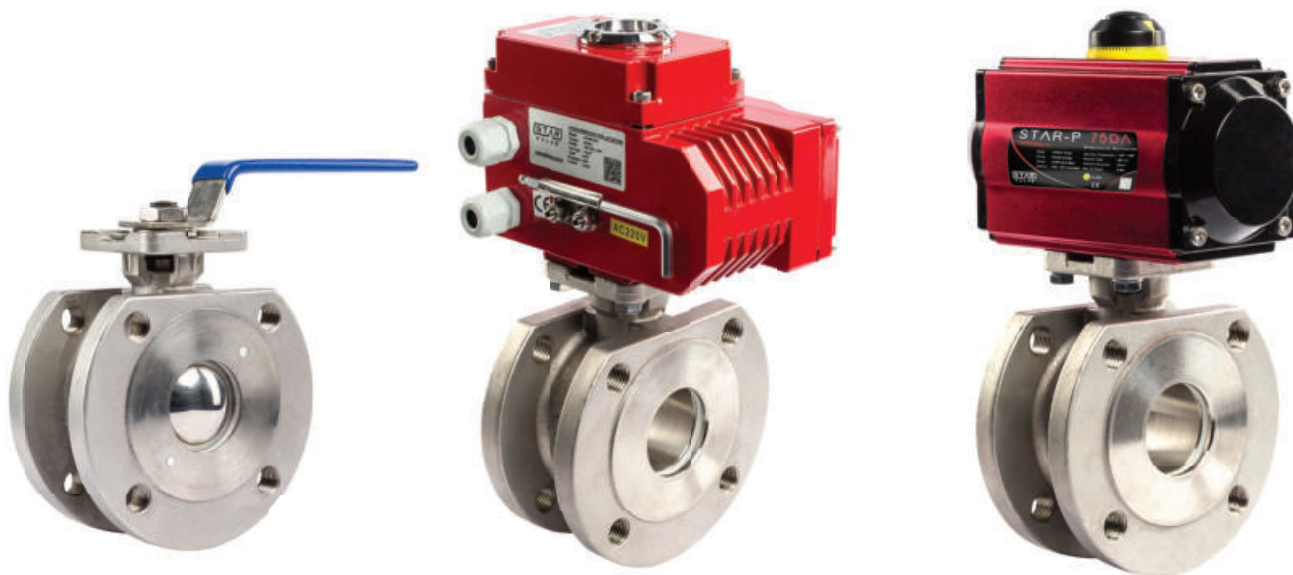

MATERIAL OPTIONS

- AISI304 Stainless Steel,
- AISI316 Stainless Steel,
- A216 WCB Carbon Steel

CONNECTION TYPE

- Flanged

ACTUATOR FEATURES

Pneumatic Actuator

- Aluminum extruded body,
- Double acting or single acting (spring return) pneumatic actuator options,
- Optional on / off switch box with mechanical or proximity limit,
- NAMUR type air valve options,
- 3-15 psi, 4-20mA input, 4-20mA input/output proportional control

Electrical Actuator

- 24V DC, 24V AC/DC, 220V AC, 110V AC power supply options,
- Proportional control with a choice of 4-20 mA,
- Manual override option in case of power failure

TECHNICAL ADVANTAGES

- DN15 – DN300 Sizes,
- Anti-static ball, shaft and body design,
- Two-piece body design enables easy maintenance,
- ISO5211 direct mounting actuator mount pad,
- Friction and wear resistant PTFE (Teflon) ball seal,
- %100 tightness test before shipment,
- DIN, ANSI norms

SV225 SERIES

LEVER / PNEUMATIC ACTUATED / ELECTRICAL ACTUATED TWO PIECES FLANGED BALL VALVES



MATERIAL OPTIONS

- AISI304 Stainless Steel,
- AISI316 Stainless Steel,
- A216 WCB Carbon Steel,
- Super Duplex

CONNECTION TYPE

- Flanged

ACTUATOR FEATURES

Pneumatic Actuator

- Aluminum extruded body,
- Double acting or single acting (spring return) pneumatic actuator options,
- Optional on / off switch box with mechanical or proximity limit,
- NAMUR type air valve options,
- 3-15 psi, 4-20mA input, 4-20mA input/output proportional control

Electrical Actuator

- 24V DC, 24V AC/DC, 220V AC, 110V AC power supply options,
- Proportional control with a choice of 4-20 mA,
- Manual override option in case of power failure

SV226 SERIES

LEVER / PNEUMATIC ACTUATED / ELECTRICAL ACTUATED THREE PIECES FLANGED BALL VALVES

TECHNICAL ADVANTAGES

- ½" – 4" sizes,
- Anti-static ball, shaft and body design,
- Friction and wearing – resistance PTFE (teflon) ball seat,
- ISO5211 according to directly assembled actuators top flanged,
- 100% tightness testing before shipment



MATERIAL OPTIONS

- AISI304 Stainless Steel,
- AISI316 Stainless Steel,
- A216 WCB Carbon Steel

CONNECTION TYPE

- Flanged

ACTUATOR FEATURES

Pneumatic Actuator

- Aluminum extruded body,
- Double acting or single acting (spring return) pneumatic actuator options,
- Optional on / off switch box with mechanical or proximity limit,
- NAMUR type air valve options,
- 3-15 psi, 4-20mA input, 4-20mA input/output proportional control

Electrical Actuator

- 24V DC, 24V AC/DC, 220V AC, 110V AC power supply options,
- Proportional control with a choice of 4-20 mA,
- Manual override option in case of power failure

TECHNICAL ADVANTAGES

- 1/4" ~ 4" sizes,
- Anti-static ball, shaft and body design,
- L-Port and T-Port working alternative,
- ISO5211 direct mounting actuator mount pad,
- Friction and wearing resistance PTFE (Teflon) ball seal,
- 100% tightness test before shipment,
- DIN, ANSI norms

SV230 SERIES

LEVER / PNEUMATIC ACTUATED / ELECTRICAL ACTUATED THREE-WAY BALL VALVES



MATERIAL OPTIONS CONNECTION TYPE

- AISI304 Stainless Steel,
- AISI316 Stainless Steel

- Threaded End

ACTUATOR FEATURES

Pneumatic Actuator

- Aluminum extruded body,
- Double acting or single acting (spring return) pneumatic actuator options,
- Optional on / off switch box with mechanical or proximity limit,
- Optional with NAMUR valve type air direction,
- 3-15 psi or proportional control with a choice of 4-20 mA

Electrical Actuator

- 24V DC, 24V AC/DC, 220V AC, 110V AC power supply options,
- Proportional control with a choice of 4-20 mA,
- Manual override option in case of power failure

SV671 SERIES

DUAL PLATE CHECK VALVES

TECHNICAL ADVANTAGES

- DN40 ~ DN600 size options,
- Low pressure loss by design,
- Fast closure when flow stops reverses thanks to dual plate,
- Low pressure loss, light moving parts and reduced energy,
- Horizontal and vertical mounting option,
- Different material options suitable for process conditions



DESIGN STANDARDS

- **Inspection and Test**
ISO 5208

APPLICATION AREA

- Chemical and Petrochemical Industry,
- Water and Process Technologies,
- In the Shipbuilding and Yacht Industry,
- HVAC

CONNECTION TYPE

- Wafer
- Lug
- Double flanged

TECHNICAL ADVANTAGES

- DN50 ~ DN1200 size options,
- Bidirectional lug type knife gate valve,
- Monoblock one piece body,
- SS 304 / SS 316 / Duplex Stainless steel etc. knife material options,
- Provides high flow rates with low pressure drop,
- According to the type of fluid wide seal option (Natural Rubber , SBR , FKM , EPDM , NBR),
- The perfect solution for intensive control of fluids and solid particles,
- Fluid-accumulation-preventing body design,
- Face to face dimension in accordance with Starvalve's standard,
- 100% tightness testing before shipment,
- Working Pressure Max]:
 - DN50 ~ DN150 : 16 Bar
 - DN200 ~ DN600 : 10 Bar
 - DN700 ~ DN900 : 8 Bar
 - DN100 ~ DN1200 : 6 Bar
- DIN, ANSI norms

SV956 SERIES

SLURRY TYPE KNIFE GATE VALVES



ACCESSORIES

- Stellite coated knife for applications with high mechanical wear,
- Gear box controlled for big sizes,
- With chain control and the extension rod control options

APPLICATION AREA

- Mining Industry,
- Chemical Plants,
- Power Plants,
- Sewage Treatment

OTHER TYPES

KNIFE GATE VALVES

TECHNICAL ADVANTAGES

- DN50 – DN1200 size options,
- The perfect solution for intensive control of fluids and solid particles,
- According to the type of fluid wide seal option (Metal to Metal, EPDM, VITON, SILICONE , NBR),
- Fluid-accumulation-preventing body design,
- DIN, ANSI norms

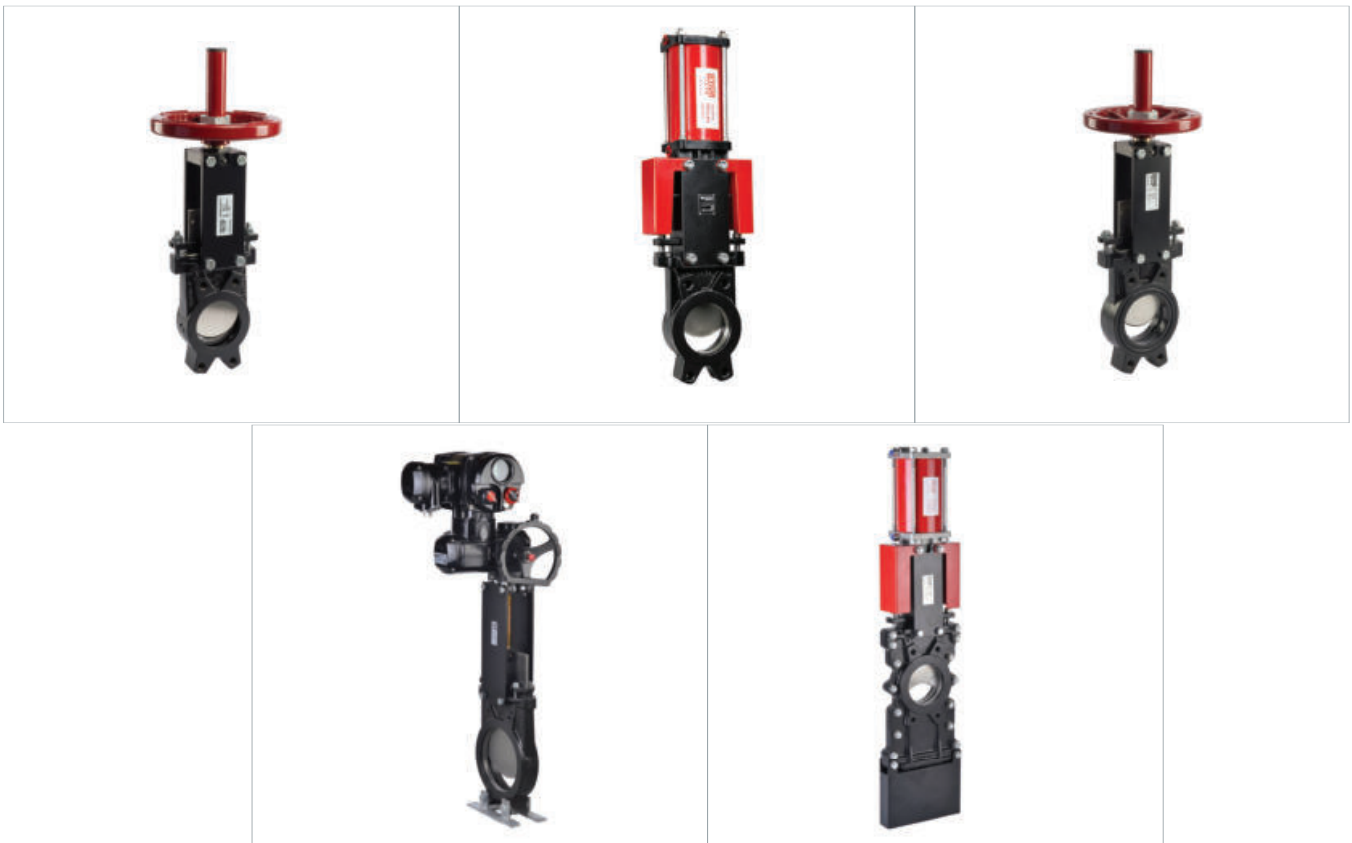

ACCESSORIES

- Cleaning the surface of the knife with stainless steel scraper,
- Stellite coated knife for applications the high mechanical wearing,
- Several holes can be drilled in the body to flush air, steam or other fluids out in order to clean the valve seat before sealing,
- Gear box controlled for big sizes,
- Lever handle controlled in emergency application, with chain control and the extension rot controls options

APPLICATION AREA

- Applications in Wastewater and Sludge,
- Chemical Industry,
- Dms and Hydrological Projects,
- Food Industry,
- Mining Industry,
- Concrete Plants,
- Under Silo Applications,
- Paper Pulp Industry

CONNECTION TYPE

- Manual Handwheel,
- Gearbox Operated,
- Pneumatic Actuated,
- Electric Actuated

TECHNICAL ADVANTAGES

- DN25 - DN250 Size wafer type,
- DN25 - DN500 size double flange type,
- With V-port ball linear control,
- PTFE and Metal seat (Stellite coated AISI316 Stainless steel) options,
- Stellite coated AISI316 with Stainless steel seat, in the high temperature and mechanical wearing resistance,
- Hard chrome coated AISI316 with Stainless steel ball, in the high temperature and Mechanical wearing resistance,
- ISO5211 direct mounting actuator mount pad,
- On/off with low torque,
- 10, 16, 25 bar pressure class,
- 100% tightness test before shipment,
- DIN, ANSI norms

SV228 / SV229 SERIES

V-PORT SEGMENT BALL VALVES



DESIGN STANDARDS

- **Flange Standards**
ASME B16.5,
DIN 2501

ACTUATOR FEATURES

- Aluminum extruded body,
- Double acting or single acting (spring return) pneumatic actuator options,
- Optional on / off switch box with mechanical or proximity limit,
- NAMUR type air valve options,
- 3-15 psi, 4-20mA input,
4-20mA input/output proportional control

APPLICATION AREA

- Mining Industry,
- Chemical Plants,
- Power Plants,
- Sewage Treatment

SV971 SERIES

MANUAL / PNEUMATIC ACTUATED PINCH VALVES

TECHNICAL ADVANTAGES

- DN50 – DN450 sizes,
- Cast Iron and Carbon Steel Body options,
- Two split bodies design for easy dismantling to change new sleeves,
- Dust-proof cover design,
- Handwheel, Pneumatic, Electrical or Hydraulic Actuator control options



DESIGN STANDARDS

• **Flange Standards**

ASME B16.5,
DIN 2501

• **Inspection and Test**

VI Class (Zero Leakage)

ACTUATOR FEATURES

- Aluminum extruded body,
- Double acting or single acting (spring return) pneumatic actuator options,
- Optional on / off switch box with mechanical or proximity limit,
- 3-15 psi or proportional control with a choice of 4-20 mA

APPLICATION AREA

- Applications in Wastewater and Sludge,
- Chemical Industry,
- Dms and Hydrological Projects,
- Food Industry,
- Mining Industry,
- Concrete Plants,
- Under Silo Applications,
- Paper Pulp Industry



STAR-P 75DA
PNEUMATIC ACTUATOR

Model	: STAR-P 75 DA	Operation Temperature	: -20° - +60°
Acting	: Double Acting	Rotation Angle	: 90° ± 5
Stroke	: 45mm (1.8 inch)	Pressure Connection	: G1/4"
Weight	: 1.80 kg (4.0 lbs)	Max. Air Supply	: 8 Bar

STAR VALVE
CE

**PFA / PTFE
(TEFLON) LINED
PRODUCTS**

TECHNICAL ADVANTAGES

- DN40 - DN1600 sizes,
- Provides high corrosion resistance, especially against hydrochloric, nitric, and sulfuric acids,
- Wafer type, lug type and double flanges body options,
- Ductile iron / steel cast body more rigid structure for industrial service,
- Min. 3 mm PTFE (Teflon) lined on stainless steel disc,
- With widely seat pressing surface, better tightness and easily mounting,
- With two piece body design, easily maintenance,
- 100% tightness testing before shipment

SV350 SERIES

PTFE (TEFLON) LINED BUTTERFLY VALVES



MATERIAL OPTIONS

- **Body;** GG40 Ductile Iron, WCB Carbon Steel, AISI 304 Stainless Steel, AISI 316 Stainless Steel
- **Disc;** AISI 316 Stainless Steel or Min.3mm PTFE (Teflon) coated AISI 304 Stainless Steel

CONTROL OPTIONS

- Gear box or with lever handle control,
- ISO 5211 Top Flange,
- On / Off or Proportional Control, Single or Double Acting Pneumatic Actuator,
- On / Off or Proportional Control, 24V DC, 24V AC/DC, 220V AC, 110V AC Electric Actuator

APPLICATION AREA

- Chemical and Petrochemical Industry,
- Chlor - Alkali Plant,
- Hydrochloric / sulfuric acid etc. and corrosive applications,
- Fertilizer Factory,
- Mining Industry,
- Sugar Process,
- Ship Industry

SV460 SERIES

PFA (TEFLON) LINED DIAPHRAGM VALVES

TECHNICAL ADVANTAGES

- DN15 ~ DN300 sizes,
- Provides high corrosion resistance, especially against hydrochloric, nitric, and sulfuric acids,
- With steel cast body more rigid structure for industrial service,
- 3mm PFA (Teflon) lined,
- 100% tightness testing before shipment



MATERIAL OPTIONS

- **Body;** GGG40 Ductile Iron, WCB Carbon Steel, AISI 304 Stainless Steel, AISI 316 Stainless Steel

- **Lining;** PFA, FEP, POM

- **Diaphragm;** PFA, FEP

CONTROL OPTIONS

- Manual Handwheel,
- On / Off and Proportional Control, Single or Double Acting Pneumatic Actuator

APPLICATION AREA

- Chemical and Petrochemical Industry,
- Chlor - Alkali Plant,
- Hydrochloric / sulfuric acid etc. and corrosive applications,
- Fertilizer Factory,
- Mining Industry,
- Sugar Process,
- Ship Industry

TECHNICAL ADVANTAGES

- DN50 - DN300 sizes,
- Provides high corrosion resistance, especially against hydrochloric, nitric, and sulfuric acids,
- With steel cast body more rigid structure for industrial service,
- 3mm PFA (Teflon) lined,
- 100% tightness testing before shipment

SV261 SERIES

PFA (TEFLON) LINED PLUG VALVES



MATERIAL OPTIONS

- **Body;** WCB Carbon Steel, AISI 304 Stainless Steel, AISI 316 Stainless Steel
- **Lining;** Min.3mm PFA, FEP, POM
- **Plug;** Min3.mm Lined Carbon Steel, AISI 304 Stainless Steel, AISI 316 Stainless Steel

CONTROL OPTIONS

- Gear box or with lever handle manual control,
- ISO5211 Direct actuator mounting mount pad,
- On / Off and Proportional Control, Single or Double Acting Pneumatic Actuator,
- On / Off or Proportional Control, 24V DC, 24V AC/DC, 220V AC, 110V AC Electric Actuator

APPLICATION AREA

- Chemical and Petrochemical Industry,
- Chlor - Alkali Plant,
- Hydrochloric / sulfuric acid etc. and corrosive applications,
- Fertilizer Factory,
- Mining Industry,
- Sugar Process,
- Ship Industry

SV250 SERIES

PTFE (TEFLON) LINED BALL VALVES

TECHNICAL ADVANTAGES

- DN15 ~ DN350 sizes,
- Provides high corrosion resistance, especially against hydrochloric, nitric, and sulfuric acids,
- Min. 3mm PFA (Teflon) lined,
- Carbon steel or stainless steel body material options,
- Friction and wear-resistant PTFE (Teflon) ball seals,
- 100% tightness testing before shipment



MATERIAL OPTIONS

- **Body;**
GGG40 Ductile Iron,
WCB Carbon Steel,
AISI 316 Stainless Steel,
AISI 316 Stainless Steel
- **Lining;**
PFA, FEP, POM

CONTROL OPTIONS

- Gear box or with lever handle control,
- ISO 5211 Top Flange,
- On / Off or Proportional Control, Single or Double Acting Pneumatic Actuator,
- On / Off or Proportional Control, 24V DC, 24V AC/DC, 220V AC, 110V AC Electric Actuator

APPLICATION AREA

- Chemical and Petrochemical Industry,
- Chlor - Alkali Plant,
- Hydrochloric / sulfuric acid etc. and corrosive applications,
- Fertilizer Factory,
- Mining Industry,
- Sugar Process,
- Ship Industry

TECHNICAL ADVANTAGES

- 1/2" ~ 16" (DN15 ~ DN400) Size Options ,
- SV656 Series (Flanged Type Swing Check Valve), SV650 Series (Flanged Type Ball Check Valve),
- Provides high corrosion resistance, especially hydrochloric acid, nitric acid, liquid chlorine, sulfuric acid etc.
- 3mm PFA (Teflon) lined,
- Carbon steel and stainless steel body options,
- 100% tightness test before shipment

SV656/650 SERIES

PFA (TEFLON) LINED CHECK VALVES



MATERIAL OPTIONS

•**Body;** WCB Carbon Steel, AISI 304 Stainless Steel, AISI 316 Stainless Steel

•**Lining;** min 3mm PFA(Teflon) Lined, FEP, POM

•**Plug;** Min3.mm Lined Carbon Steel, AISI 304 Stainless Steel, AISI 316 Stainless Steel

CONTROL OPTIONS

•**Design Standards**
API 6D

•**Face to Face**
ASME B16.10

•**Flange Standards**
ASME B16.5, JISB2220

•**Inspection and Testing**
API598

APPLICATION AREA

- Chemical and Petrochemical Industry,
- Chlor - Alkali Plant,
- Hydrochloric / sulfuric acid etc. and corrosive applications,
- Fertilizer Factory,
- Mining Industry,
- Sugar Process,
- Ship Industry

SV910P SERIES

PTFE (TEFLON) EXPANSION JOINT

TECHNICAL ADVANTAGES

- DN25 ~ DN600 sizes,
- Provides high corrosion resistance, especially against hydrochloric, nitric, and sulfuric acids,
- Expansion joints can be with three convolutions as a standard. More than three convolutions can be customized,
- 100% tightness testing before shipment



MATERIAL OPTIONS

- **Flange;**
A105 Carbon Steel,
AISI 304 Stainless Steel,
AISI 316 Stainless Steel,
AISI 316L Stainless Steel
- **Bellows;** Min.3mm PTFE (TEFLON)

CONNECTION TYPE OPTIONS

- Flanged

APPLICATION AREA

- Chemical and Petrochemical Industry,
- Chlor - Alkali Plant,
- Hydrochloric / sulfuric acid etc. and corrosive applications,
- Fertilizer Factory,
- Mining Industry,
- Sugar Process,
- Ship Industry

TECHNICAL ADVANTAGES

- DN25 - DN300 size options,
- Pipe length; Size ≤DN150 L:6.000mm
Size >DN150 L:4.000mm
- Strong acids, alkalis, organic solvents, flammable and toxic fluid resistant,
- 200°C max working temperature,
- DIN, ANSI, JIS Norms

SV930P SERIES

PTFE / PFA (TEFLON) LINED PIPE AND FITTINGS





ALFA V100

ELECTRICAL ACTUATOR

STARVALVE.COM.TR



Model : Alfa-V100 Current : 0.25A
Torque : 100 Nm Control Type : On / Off
Supply : 220V AC Working Angle : 0 90
Power : 10W Protection : IP67



STARVALVE
SV210 SERIES U-PVC
TRUE UNION BALL VALVE
R2" (DN3mm) - PN10
SEAT: PTFE SEALS: EPDM
www.starvalve.com.tr

THERMOPLASTIC PRODUCTS

SV210 SERIES

DOUBLE UNION INDUSTRIAL TYPE BALL VALVES

TECHNICAL ADVANTAGES

- 1/2" - 4" sizes,
- Drinking water standards,
- CaCO3 calcite free 100% pure virgin material,
- UV resistant powder added,
- Specially designed for heavy industrial applications,
- Double o-ring shaft design,
- Friction and wearing resistance PTFE (Teflon) ball seal,
- Reduces wear on the PTFE seat with back-up o-ring for frequently opening/closing applications,
- Safe mounting with a special locking ball system,
- Water applications EPDM O-ring, Acidic applications VITON O-ring alternatives,
- Made of stainless steel material with bracket&shaft ISO5211 directly according to mounting actuator top flanged,
- 100% tightness testing before shipment,
- DIN, ANSI, JIS norms



MATERIAL OPTIONS

- U-PVC MAXIMUM 55°C
- C-PVC MAXIMUM 95°C
- PP-H MAXIMUM 95°C
- PVDF MAXIMUM 140°C
- CLEAR-PVC MAXIMUM 55°C

CONNECTION TYPE

- Socket Solvent Cement (U-PVC, C-PVC),
- Threaded End (U-PVC, C-PVC, PP-H, PVDF),
- Socket Welded (PP-H - PVDF),
- Butt Welded (PP-H - PVDF)

TECHNICAL DRAWING

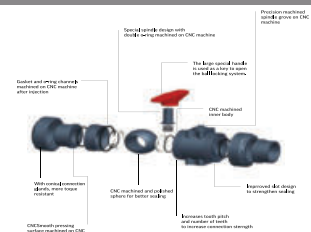

TECHNICAL ADVANTAGES

- 1/2" - 4" sizes,
- Drinking water standards,
- CaCO₃ calcite free 100% pure virgin material,
- UV resistant powder added,
- Specially designed for heavy industrial applications,
- Double o-ring shaft design,
- Friction and wearing resistance
PTFE (Teflon) ball seal,
- Reduces wear on the PTFE seat with back-up
o-ring for frequently opening/closing applications,
- Safe mounting with a special locking ball system,
- Water applications EPDM O-ring, Acidic applications
VITON O-ring alternatives,
- Made of stainless steel material with bracket&shaft ISO5211
directly according to mounting actuator top flanged,
- 100% tightness testing before shipment,
- DIN, ANSI, JIS norms

SV210 SERIES

PNEUMATIC ACTUATED INDUSTRIAL TYPE BALL VALVES



MATERIAL OPTIONS

- U-PVC MAXIMUM 55°C
- C-PVC MAXIMUM 95°C
- PP-H MAXIMUM 95°C
- PVDF MAXIMUM 140°C
- CLEAR-PVC MAXIMUM 55°C

CONNECTION TYPE

- Socket Solvent Cement (U-PVC, C-PVC),
- Threaded End (U-PVC, C-PVC, PP-H, PVDF),
- Socket Welded (PP-H - PVDF),
- Flanged (U-PVC, C-PVC, PP-H, PVDF),
- Butt Welded (PP-H - PVDF)

ACTUATOR FEATURES

- Aluminum extruded body,
- Double acting or single acting
(spring return) pneumatic actuator options,
- Optional on / off switch box with
mechanical or proximity limit,
- NAMUR type air valve options,
- 3-15 psi, 4-20mA input,
4-20mA input/output proportional control

SV210 SERIES

ELECTRICAL ACTUATED INDUSTRIAL TYPE BALL VALVES

TECHNICAL ADVANTAGES

- ½" ~ 4" sizes,
- Drinking water standards,
- CaCO3 calcite free 100% pure virgin material,
- UV resistant powder added,
- Specially designed for heavy industrial applications,
- Double o-ring shaft design,
- Friction and wearing resistance PTFE (Teflon) ball seal,
- Reduces wear on the PTFE seat with back-up o-ring for frequently opening/closing applications,
- Safe mounting with a special locking ball system,
- Water applications EPDM O-ring, Acidic applications VITON O-ring alternatives,
- Made of stainless steel material with bracket&shaft ISO5211 directly according to mounting actuator top flanged,
- 100% tightness testing before shipment,
- DIN, ANSI, JIS norms

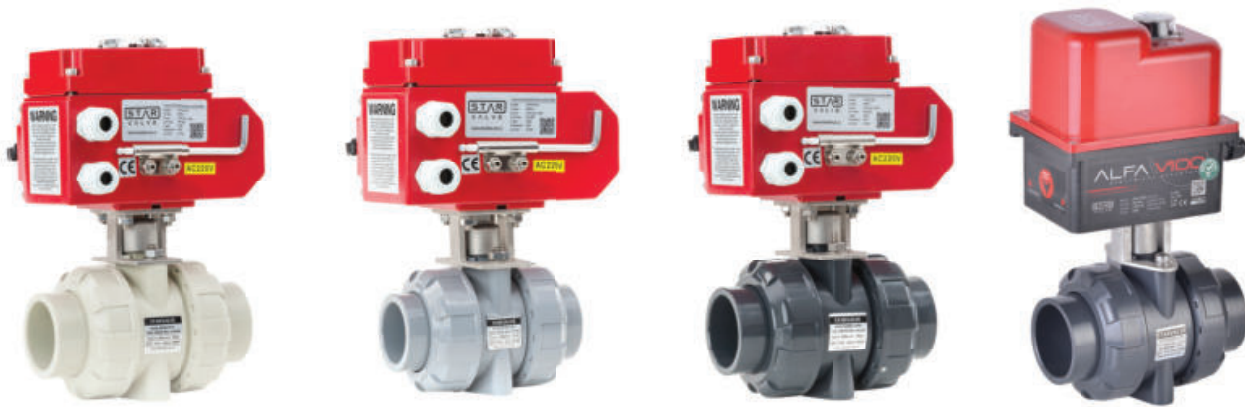

MATERIAL OPTIONS

- U-PVC MAXIMUM 55°C
- C-PVC MAXIMUM 95°C
- PP-H MAXIMUM 95°C
- PVDF MAXIMUM 140°C
- CLEAR-PVC MAXIMUM 55°C

CONNECTION TYPE

- Socket Solvent Cement (U-PVC, C-PVC),
- Threaded End (U-PVC, C-PVC, PP-H, PVDF),
- Socket Welded (PP-H - PVDF),
- Flanged (U-PVC, C-PVC, PP-H, PVDF),
- Butt Welded (PP-H - PVDF)

ACTUATOR FEATURES

- 24V DC, 24V AC/DC, 220V AC, 110V AC power supply options,
- Proportional control with a choice of 4-20 mA,
- Manual override option in case of power failure

SV231 SERIES

TECHNICAL ADVANTAGES

- 3/8" - 2" (DN10 - DN50) sizes,
- Both L-type and T-type working option,
- Drinking water standards,
- CaCO3 calcite free 100% pure virgin material,
- UV resistant powder added,
- Specially designed for heavy industrial applications,
- Water applications EPDM O-ring, Acidic applications VITON O-ring alternatives,
- Made of PPS material with bracket&shaft ISO5211 directly according to mounting actuator top flanged,
- 100% tightness testing before shipment,
- Working pressure Max:10 Bar,
- DIN, ANSI, JIS Norms

MANUAL THREE-WAY BALL VALVES



MATERIAL OPTIONS

- U-PVC MAXIMUM 55°C
- C-PVC MAXIMUM 95°C
- PP-H MAXIMUM 95°C
- PVDF MAXIMUM 140°C

CONNECTION TYPE

- Socket Solvent Cement (U-PVC, C-PVC),
- Threaded End (U-PVC, C-PVC, PP-H, PVDF),
- Socket Welded (PP-H - PVDF),
- Butt Welded (PP-H - PVDF),
- Flanged

APPLICATION AREA

- Chemical and Petrochemical Industry,
- Water and Process Technologies,
- In the Shipbuilding and Yacht Industry,
- Electrolysis Premises,
- Mining Industry,
- Food Industry,
- Cooling Systems,
- Coating Plant

SV231 SERIES

PNEUMATIC ACTUATED THREE-WAY BALL VALVES

TECHNICAL ADVANTAGES

- 3/8" ~ 2" (DN10 ~ DN50) sizes,
- Both L-type and T-type working option,
- Drinking water standards,
- CaCO3 calcite free 100% pure virgin material,
- UV resistant powder added,
- Specially designed for heavy industrial applications,
- Water applications EPDM O-ring, Acidic applications VITON O-ring alternatives,
- Made of PPS material with bracket&shaft ISO5211 directly according to mounting actuator top flanged,
- 100% tightness testing before shipment,
- Working pressure Max:10 Bar,
- DIN, ANSI, JIS Norms



MATERIAL OPTIONS

- U-PVC MAXIMUM 55°C
- C-PVC MAXIMUM 95°C
- PP-H MAXIMUM 95°C
- PVDF MAXIMUM 140°C

CONNECTION TYPE

- Socket Solvent Cement (U-PVC, C-PVC),
- Threaded End (U-PVC, C-PVC, PP-H, PVDF),
- Socket Welded (PP-H - PVDF),
- Butt Welded (PP-H - PVDF),
- Flanged

ACTUATOR FEATURES

- Aluminum extruded body,
- Double acting or single acting (spring return) pneumatic actuator options,
- Optional on / off switch box with mechanical or proximity limit,
- NAMUR type air valve options,
- 3-15 psi, 4-20mA input, 4-20mA input/output proportional control

SV231 SERIES

TECHNICAL ADVANTAGES

- 3/8" ~ 2" (DN10 ~ DN50) sizes,
- Both L-type and T-type working option,
- Drinking water standards,
- CaCO₃ calcite free 100% pure virgin material,
- UV resistant powder added,
- Specially designed for heavy industrial applications,
- Water applications EPDM O-ring, Acidic applications VITON O-ring alternatives,
- Made of PPS material with bracket&shaft ISO5211 directly according to mounting actuator top flanged,
- 100% tightness testing before shipment,
- Working pressure Max:10 Bar,
- DIN, ANSI, JIS Norms

ELECTRICAL ACTUATED THREE-WAY BALL VALVES



MATERIAL OPTIONS

- U-PVC MAXIMUM 55°C
- C-PVC MAXIMUM 95°C
- PP-H MAXIMUM 95°C
- PVDF MAXIMUM 140°C

CONNECTION TYPE

- Socket Solvent Cement (U-PVC, C-PVC),
- Threaded End (U-PVC, C-PVC, PP-H, PVDF),
- Socket Welded (PP-H - PVDF),
- Butt Welded (PP-H - PVDF),
- Flanged

ACTUATOR FEATURES

- 24V DC, 24V AC/DC, 220V AC, 110V AC power supply options,
- Proportional control with a choice of 4-20 mA,
- Manual override option in case of power failure

SV120 (FE SERIES)

HAND LEVER ECONOMICAL TYPE BUTTERFLY VALVES

TECHNICAL ADVANTAGES

- 1½" – 8" (DN 40 – DN200) sizes,
- Bi-directional centric butterfly valve,
- DN40 – DN50 : PN16, DN65 – DN200 : PN10 (with water at 20°C) nominal pressures,
- EN ISO 1452, EN ISO 15493, DIN 2501, ISO 7005-1, EN 1092-1, ASTM B16.5 Cl.150 flanging standards,
- EN ISO 16136, EN ISO 1452, EN ISO 15493 construction criteria,
- ISO 9393 test methods and requirements,
- ISO 5211 actuator couplings,
- PVC-U disc and body,
- Zinc plated carbon steel (C45). On request Stainless Steel AISI 316 stem,
- Liner; EPDM,FKM. On request NBR seal material,
- Hand Lever Operated, Gearbox, Pneumatic Actuated, Electric Actuated Control Options,
- The wafer valve can be transformed into a one-way Lug body valve thanks to the set of zinc plated steel inserts available as an optional extra



MATERIAL OPTIONS

- U-PVC MAXIMUM 55°C

CONNECTION TYPE

- Wafer type butterfly valve,
- Wafer type butterfly valve with flanged set

TECHNICAL DRAWING



TECHNICAL ADVANTAGES

- 1½" ~ 8" (DN 40 ~ DN200) sizes,
- Bi-directional centric butterfly valve,
- DN40 ~ DN50 : PN16, DN65 ~ DN200 : PN10 (with water at 20°C) nominal pressures,
- EN ISO 1452, EN ISO 15493, DIN 2501, ISO 7005-1, EN 1092-1, ASTM B16.5 Cl.150 flanging standards,
- EN ISO 16136, EN ISO 1452, EN ISO 15493 construction criteria,
- ISO 9393 test methods and requirements,
- ISO 5211 actuator couplings,
- PVC-U disc and body,
- Zinc plated carbon steel (C45). On request Stainless Steel AISI 316 stem,
- Liner; EPDM,FKM. On request NBR seal material,
- The wafer valve can be transformed into a one-way Lug body valve thanks to the set of zinc plated steel inserts available as an optional extra

SV120 (FE SERIES)

PNEUMATIC ACTUATED ECONOMICAL TYPE BUTTERFLY VALVES

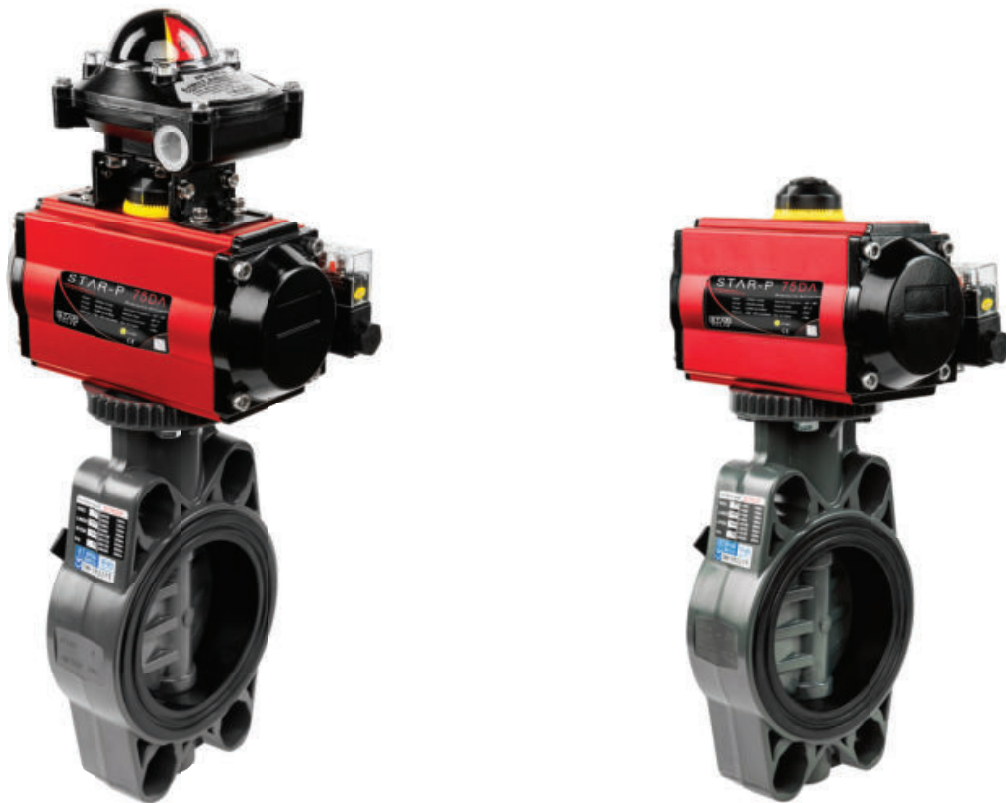

MATERIAL OPTIONS

- U-PVC MAXIMUM 55°C

CONNECTION TYPE

- Wafer type butterfly valve,
- Wafer type butterfly valve with flanged set

ACTUATOR FEATURES

- Aluminum extruded body,
- Double acting or single acting (spring return) pneumatic actuator options,
- Optional on / off switch box with mechanical or proximity limit,
- NAMUR type air valve options,
- 3-15 psi, 4-20mA input, 4-20mA input/output proportional control

SV120 (FE SERIES)

ELECTRICAL ACTUATED ECONOMICAL TYPE BUTTERFLY VALVES

TECHNICAL ADVANTAGES

- 1½" – 8" (DN 40 – DN200) sizes,
- Bi-directional centric butterfly valve,
- DN40 – DN50 : PN16, DN65 – DN200 : PN10 (with water at 20°C) nominal pressures,
- EN ISO 1452, EN ISO 15493, DIN 2501, ISO 7005-1, EN 1092-1, ASTM B16.5 Cl.150 flanging standards,
- EN ISO 16136, EN ISO 1452, EN ISO 15493 construction criteria,
- ISO 9393 test methods and requirements,
- ISO 5211 actuator couplings,
- PVC-U disc and body,
- Zinc plated carbon steel (C45). On request Stainless Steel AISI 316 stem,
- Liner; EPDM,FKM. On request NBR seal material,
- The wafer valve can be transformed into a one-way Lug body valve thanks to the set of zinc plated steel inserts available as an optional extra



MATERIAL OPTIONS

- U-PVC MAXIMUM 55°C

CONNECTION TYPE

- Wafer type butterfly valve,
- Wafer type butterfly valve with flanged set

ACTUATOR FEATURES

- 24V DC, 24V AC/DC, 220V AC, 110V AC power supply options,
- Proportional control with a choice of 4-20 mA,
- Manual override option in case of power failure

TECHNICAL ADVANTAGES

- 1½" ~ 16" (DN 40 ~ DN400) sizes,
- Bi-directional centric butterfly valve,
- EN ISO 1452, EN ISO 15493, DIN 2501, ISO 7005-1, EN 1092-1, ASTM B16.5 CL.150 flanging standards,
- EN ISO 16136, EN ISO 1452, EN ISO 15493 construction criteria,
- ISO 9393 test methods and requirements,
- ISO 5211 actuator couplings,
- PP-GR (Polypropylene - Glass Reinforced) body,
- PVC-U/PVC-C/PP-H/PVDF disc,
- Stainless Steel AISI 316 stem,
- Liner; EPDM, FKM. On request NBR seal material,
- Hand Lever Operated (DN40 ~ DN200); Gearbox, Pneumatic Actuated, Electric Actuated Control Options

SV120 (FK SERIES)

MANUAL INDUSTRIAL TYPE BUTTERFLY VALVES



MATERIAL OPTIONS

- U-PVC MAXIMUM 55°C
- C-PVC MAXIMUM 95°C
- PP-H MAXIMUM 95°C
- PVDF MAXIMUM 140°C

CONNECTION TYPE

- Wafer type butterfly valve,
- Wafer type butterfly valve with flanged set,
- Lug type butterfly valve,
- Lug type butterfly valve with flanged set

TECHNICAL DRAWING



SV120 (FK SERIES)

PNEUMATIC ACTUATED INDUSTRIAL TYPE BUTTERFLY VALVES

TECHNICAL ADVANTAGES

- 1½" - 16" (DN 40 - DN400) sizes,
- Bi-directional centric butterfly valve,
- EN ISO 1452, EN ISO 15493, DIN 2501, ISO 7005-1, EN 1092-1, ASTM B16.5 Cl.150 flanging standards,
- EN ISO 16136, EN ISO 1452, EN ISO 15493 construction criteria,
- ISO 9393 test methods and requirements,
- ISO 5211 actuator couplings,
- PP-GR (Polypropylene - Glass Reinforced) body,
- PVC-U/PVC-C/PP-H/PVDF disc,
- Stainless Steel AISI 316 stem,
- Liner; EPDM,FKM. On request NBR seal material,
- Hand Lever Operated (DN40 - DN200); Gearbox, Pneumatic Actuated,Electric Actuated Control Options,
- Developed for heavy industrial application special rigid design



MATERIAL OPTIONS

- U-PVC MAXIMUM 55°C
- C-PVC MAXIMUM 95°C
- PP-H MAXIMUM 95°C
- PVDF MAXIMUM 140°C

CONNECTION TYPE

- Wafer type butterfly valve,
- Wafer type butterfly valve with flanged set,
- Lug type butterfly valve,
- Lug type butterfly valve with flanged set,

ACTUATOR FEATURES

- Aluminum extruded body,
- Double acting or single acting (spring return) pneumatic actuator options,
- Optional on / off switch box with mechanical or proximity limit,
- NAMUR type air valve options,
- 3-15 psi, 4-20mA input,
- 4-20mA input/output proportional control

TECHNICAL ADVANTAGES

- 1½" - 16" (DN 40 - DN400) sizes,
- Bi-directional centric butterfly valve,
- EN ISO 1452, EN ISO 15493, DIN 2501, ISO 7005-1, EN 1092-1, ASTM B16.5 Cl.150 flanging standards,
- EN ISO 16136, EN ISO 1452, EN ISO 15493 construction criteria,
- ISO 9393 test methods and requirements,
- ISO 5211 actuator couplings,
- PP-GR (Polypropylene - Glass Reinforced) body,
- PVC-U/PVC-C/PP-H/PVDF disc,
- Stainless Steel AISI 316 stem,
- Liner; EPDM, FKM. On request NBR seal material,
- Hand Lever Operated (DN40 - DN200); Gearbox, Pneumatic Actuated, Electric Actuated Control Options

SV120 (FK SERIES)

ELECTRICAL ACTUATED INDUSTRIAL TYPE BUTTERFLY VALVES



MATERIAL OPTIONS

- U-PVC MAXIMUM 55°C
- C-PVC MAXIMUM 95°C
- PP-H MAXIMUM 95°C
- PVDF MAXIMUM 140°C

CONNECTION TYPE

- Wafer type butterfly valve,
- Wafer type butterfly valve with flanged set,
- Lug type butterfly valve,
- Lug type butterfly valve with flanged set,

ACTUATOR FEATURES

- 24V DC, 24V AC/DC, 220V AC, 110V AC power supply options,
- Proportional control with a choice of 4-20 mA,
- Manual override option in case of power failure

DK SERIES

INDUSTRIAL TYPE DIAPHRAGM VALVES

TECHNICAL ADVANTAGES

- ½" ~ 2½" (DN15 ~ DN65) sizes,
- Diaphragm valve with maximized flow rate and DIALOCK® lockable handwheel,
- PN 10 (with water at 20°C) nominal pressure,
- U-PVC / C-PVC / PP-H / PVDF body,
- PP-GR bonnet and handwheel,
- PVC position indicator cap,
- EPDM, FKM, PTFE (on request NBR) diaphragm material,
- Manual Control, Pneumatic Actuated Control Options,
- Optimised fluid dynamic design: maximum output flow rate thanks to the optimised efficiency of the fluid dynamics that characterise the new internal geometry of the body,
- Internal components in metal, totally isolated from the fluid and external environment



MATERIAL OPTIONS

- U-PVC MAXIMUM 55°C
- C-PVC MAXIMUM 95°C
- PP-H MAXIMUM 95°C
- PVDF MAXIMUM 140°C

CONNECTION TYPE

- Socket Solvent Cement (U-PVC, C-PVC),
- Threaded End (U-PVC, C-PVC, PP-H, PVDF),
- Socket Welded (PP-H - PVDF),
- Flanged (U-PVC, C-PVC, PP-H, PVDF),
- Butt Welded (PP-H - PVDF)

APPLICATION AREA

- Chemical and Petrochemical Industry,
- Water and Process Technologies,
- In the Shipbuilding and Yacht Industry,
- Electrolysis Premises,
- Mining Industry,
- Food Industry,
- Cooling Systems,
- Coating Plant

TECHNICAL ADVANTAGES

- 3" - 4" (DN80 - DN100) sizes,
- Diaphragm valve with maximized flow rate and DIALOCK® lockable handwheel / Single wear diaphragm valve construction,
- PN10 with water at 20°C, PN6 with water at 20°C (PTFE Version) nominal pressure,
- U-PVC / C-PVC / PP-H / PVDF body,
- PP-GR bonnet and handwheel,
- PA-GR position indicator cap,
- EPDM, FKM, PTFE (on request NBR) diaphragm material,
- Manual Control, Pneumatic Actuated Control Options,
- Optimised fluid dynamic design: maximum output flow rate thanks to the optimised efficiency of the fluid dynamics that characterise the new internal geometry of the body,
- Internal operating components in metal totally isolated from the conveyed fluid

VM SERIES

INDUSTRIAL TYPE DIAPHRAGM VALVES



MATERIAL OPTIONS

- U-PVC MAXIMUM 55°C
- C-PVC MAXIMUM 95°C
- PP-H MAXIMUM 95°C
- PVDF MAXIMUM 140°C

CONNECTION TYPE

- Flanged (U-PVC, C-PVC, PP-H, PVDF),
- Socket Solvent Cement (U-PVC, C-PVC),
- Socket Welded (PP-H and PVDF)

TECHNICAL DRAWING



DK SERIES

PNEUMATIC ACTUATED DIAPHRAGM VALVES

TECHNICAL ADVANTAGES

- ½" ~ 4" (DN15 ~ DN100) sizes,
- Drinking water standards,
- EPDM, FKM or PTFE (on request NBR) diaphragm material options,
- CaCO3 calcite free 100% pure virgin material,
- UV resistant powder added,
- Specially designed with rigid construction for heavy industrial applications,
- 100% tightness testing before shipment,
- Working pressure Max: 10 Bar,
- DIN, ANSI, JIS norms



MATERIAL OPTIONS

- U-PVC MAXIMUM 55°C
- C-PVC MAXIMUM 95°C
- PP-H MAXIMUM 95°C
- PVDF MAXIMUM 140°C

CONNECTION TYPE

- Socket Solvent Cement (U-PVC, C-PVC),
- Threaded End (U-PVC, C-PVC, PP-H, PVDF),
- Socket Welded (PP-H - PVDF),
- Flanged (U-PVC, C-PVC, PP-H, PVDF),
- Butt Welded (PP-H - PVDF)

ACTUATOR FEATURES

- Double acting or single acting (spring return) pneumatic actuator options,
- Optional on / off switch box with mechanical or proximity limit,
- Optional with air solenoid valve,
- Proportional control with a choice of 4-20 mA or 3-15 psi

SV610 SERIES

DOUBLE UNION INDUSTRIAL TYPE BALL CHECK VALVES

TECHNICAL ADVANTAGES

- ½" ~ 2" sizes,
- Drinking water standards,
- CaCO₃ calcite free 100% pure virgin material,
- UV resistant powder added,
- Specially designed for heavy industrial applications,
- Can be assembled vertically or horizontally,
- Water applications EPDM O-ring, Acidic applications VITON O-ring alternatives,
- 100% tightness testing before shipment,
- Working pressure Max: 10 Bar,
- DIN, ANSI, JIS norms



MATERIAL OPTIONS

- U-PVC MAXIMUM 55°C
- C-PVC MAXIMUM 95°C
- PP-H MAXIMUM 95°C
- PVDF MAXIMUM 140°C
- CLEAR-PVC MAXIMUM 55°C

CONNECTION TYPE

- Socket Solvent Cement (U-PVC, C-PVC),
- Threaded End (U-PVC, C-PVC),
- Socket Welded (PP-H)

TECHNICAL DRAWING



1. Union-end plane after turning to ensure a more reliable flatness
2. Increase the nut-solid, thread taper and laps, improved pressure-resistant
3. Thickening O-ring, more toughness, sealing better
4. Seat is designed to fix the sealing performance
5. From the platform to the half-ball seating, more reliable performance, sealing pressure levels increased (0.5kg-10kg), and it can be easily installed by horizontal or vertical
6. In the ribs from three to six, making better diversion

TECHNICAL ADVANTAGES

- 2½" ~ 8" (DN65 ~ DN200) Size Options,
- Drinking water standards,
- CaCO₃ calcite free 100% pure virgin material,
- UV resistant powder added,
- Specially designed for heavy industrial applications,
- Can be assembled vertically or horizontally,
- Water applications EPDM O-ring, Acidic applications VITON O-ring alternatives,
- 100% tightness testing before shipment,
- Working pressure Max: 10 Bar,
- DIN, ANSI, JIS norms

SV620 SERIES

INDUSTRIAL TYPE SWING CHECK VALVES



MATERIAL OPTIONS

- U-PVC MAXIMUM 55°C
- C-PVC MAXIMUM 95°C

CONNECTION TYPE

- Solvent Cement
- Flanged end

TECHNICAL DRAWING



1. In particular increase the thickness at the end of body for impact resistance strength when suddenly open
2. Two plane and the O-ring grooves are by machining, to ensure the combination of surface formation, better sealing
3. Improved design on valve rib, at the bottom to reduce weight and greatly increased due to water hammer valve impact resistance and strength
4. The abolition of the metal shaft, all to switch to all-in-one plastic structure, increased corrosion resistance
5. Buckle fixed valve petal, the elimination of the original way, replacing the two columns of fixed processing errors, and increase the opening angle to reduce the flow resistance
6. Sealing surface design is tilted 10 degrees, so that it also can use at the level of the installation
7. Lock 8 screws the upper and lower body more closely and firmly, under the water hammer, it is difficult deformation, better sealing

SV630 SERIES

SINGLE UNION INDUSTRIAL TYPE FOOT VALVES

TECHNICAL ADVANTAGES

- ½" ~ 8" (DN15 ~ DN200) Size Options,
- Drinking water standards,
- CaCO3 calcite free 100% pure virgin material,
- UV resistant powder added,
- Specially designed for heavy industrial applications,
- Can be assembled vertically or horizontally,
- Water applications EPDM O-ring, Acidic applications VITON O-ring alternatives,
- 100% tightness testing before shipment,
- Working pressure Max: 10 Bar,
- DIN, ANSI, JIS norms



MATERIAL OPTIONS

- U-PVC
- C-PVC
- PP-H
- PVDF

MAXIMUM 55°C
MAXIMUM 95°C
MAXIMUM 95°C
MAXIMUM 140°C

CONNECTION TYPE

- Solvent Cement
- Flanged end

TECHNICAL DRAWING



1. Bonnet can prevent massive objects entering into foot valve
2. Increase the nut-solid, thread taper and laps, improved pressure resistant
3. Seat is designed to fix the sealing performance
4. Thickening O-ring, more toughness, sealing better
5. Seat is designed to fix the seal
6. From the platform to half-ball sealing, more reliable performance, sealing pressure levels increased (0.5kg-10kg), and it can be easily installed by horizontal or vertical
7. In the ribs from three to six, making better diversion

TECHNICAL ADVANTAGES

- 1½" ~ 12" (DN40 ~ DN300) Size Options,
- Drinking water standards,
- CaCO₃ calcite free 100% pure virgin material,
- UV resistant powder added,
- Specially designed for heavy industrial applications,
- Can be assembled vertically or horizontally,
- 100% tightness testing before shipment,
- Working pressure Max: 10 Bar

CR / FR SERIES

WAFER TYPE SWING CHECK VALVES



MATERIAL OPTIONS

- U-PVC
- C-PVC
- PP-H
- PVDF

MAXIMUM 55°C
MAXIMUM 95°C
MAXIMUM 95°C
MAXIMUM 140°C

CONNECTION TYPE

- Wafer Type (Assembled between two flanged)

TECHNICAL DRAWING

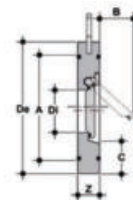

RV SERIES

Y-TYPE STRAINERS

TECHNICAL ADVANTAGES

- 3/8" ~ 4" (DN10 ~ DN100) sizes,
- Drinking water standards,
- CaCO3 calcite free 100% pure virgin material,
- UV resistant powder added,
- Specially designed for heavy industrial applications,
- 100% tightness testing before shipment,
- Working pressure Max: 10 Bar,
- DIN, ANSI, JIS Norms



MATERIAL OPTIONS

- U-PVC MAXIMUM 55°C
- C-PVC MAXIMUM 95°C
- PP-H MAXIMUM 95°C
- PVDF MAXIMUM 140°C

CONNECTION TYPE

- Solvent Cement (U-PVC, C-PVC),
- Threaded End (U-PVC, C-PVC, PP-H, PVDF),
- Socket Welded (PP-H - PVDF),
- Flanged (U-PVC, C-PVC, PP-H, PVDF),
- Butt Welded (PP-H - PVDF)

TECHNICAL DRAWING

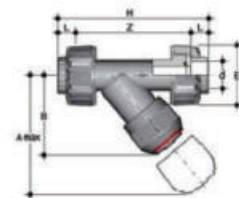

TECHNICAL ADVANTAGES

- S12 Series DN4, DN6, DN8 sizes,
- S22 Series DN8, DN10, DN15 sizes,
- 2/2 and 3/2 working alternative,
- Drinking water standards,
- IP65 protection class,
- EPDM or VITON diaphragm options,
- Corrosion resistance materials

S12/S22 SERIES

2/2 WAY SOLENOID VALVES



MATERIAL OPTIONS

- U-PVC MAXIMUM 55°C

CONNECTION TYPE

- Solvent Cement

TECHNICAL DRAWING

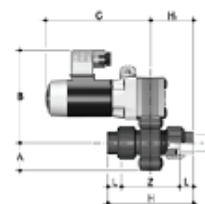

SV930T SERIES

U-PVC PIPE AND FITTINGS

TECHNICAL ADVANTAGES

- ½" ~ 12" size options,
- Heat and electrical insulation,
- Transporting/handling and mounting easily because of the lightness,
- Low coefficient of friction,
- Acid and alkaline fluid resistant,
- 55°C max working temperature,
- 16 bar Max working pressure,
- DIN, ANSI, JIS norms



TECHNICAL ADVANTAGES

- ½" ~ 24" size options,
- Socket welded and butt welded options,
- Heat and electrical insulation,
- Transporting/handling and mounting easily because of the lightness,
- Low coefficient of friction,
- Acid and alkaline fluid resistant,
- 95°C max working temperature,
- 6/10 bar Max working pressure,
- DIN, ANSI, JIS norms

SV930T SERIES

PP-H PIPE AND FITTINGS



SV930T SERIES

PVDF PIPE AND FITTINGS

TECHNICAL ADVANTAGES

- ½" ~ 12" size options,
- Heat and electrical insulation,
- Transporting/handling and mounting easily because of the lightness,
- Low coefficient of friction,
- Acid and alkaline fluid resistant,
- 140°C max working temperature,
- 10/16 bar Max working pressure,
- DIN, ANSI, JIS norms



TECHNICAL ADVANTAGES

- ½" ~ 12" size options,
- Heat and electrical insulation,
- Transporting/handling and mounting easily because of the lightness,
- Low coefficient of friction,
- Acid and alkaline fluid resistant,
- 95°C max working temperature,
- 10/16 bar Max working pressure,
- DIN, ANSI, JIS norms

SV930T SERIES

C-PVC PIPE AND FITTINGS



SV930T SERIES

CLEAR PVC PIPE AND FITTINGS

TECHNICAL ADVANTAGES

- ½" ~ 8" size options,
- When you need to visually monitor whatever is passing through the piping systems,
- Heat and electrical insulation,
- Transporting/handling and mounting easily because of the lightness,
- Low coefficient of friction,
- Acid and alkaline fluid resistant,
- 55°C max working temperature,
- 10 and 16 bar Max working pressure,
- DIN, ANSI, JIS norms



TECHNICAL ADVANTAGES

- $\frac{3}{8}$ " ~ 12" Sizes,
- Lightweight and easy to install,
- Wide operating temperature -40°C to +60°C,
- Working pressure max: PN16,
- 50- year design life,
- Corrosion and impact resistant,
- Low thermal conductivity helps to reduce "temperature loss,
- Fully matched range of pipe, fittings and valves,
- Full WRAS approval

SV930T SERIES

ABS PIPE AND FITTINGS





WATERWORKS GROUP



SV362 SERIES

DOUBLE ECCENTRIC DOUBLE FLANGED END BUTTERFLY VALVES

TECHNICAL ADVANTAGES

- DN100 ~ DN2200 Sizes available,
- 100% watertight sealing performance,
- Suitable for flow regulation and sectioning,
- Suitable for line type vertical mounting,
- Double eccentric design for drinking water and neutral liquids up to 70°C,
- High-quality EN-GJS-400-15 ductile iron body and disc,
- AISI 420 stainless steel upper and lower stems,
- A2 stainless steel bolts for enhanced corrosion resistance,
- PN10 bi-directional seal as standard (PN16 & PN25 options available),
- Mechanical gearbox and position indicator included,
- ISO 5211 top flange for easy actuator mounting.



ACTUATOR FEATURES

Pneumatic Actuator

- Aluminum extruded body,
- Double acting or single acting (spring return) pneumatic actuator options,
- Optional on / off switch box with mechanical or proximity limit,
- NAMUR type air valve options,
- 3-15 psi, 4-20mA input, 4-20mA input/output proportional control

Electrical Actuator

- 24V DC, 24V AC/DC, 220V AC, 380V AC power supply options,
- Proportional control with a choice of 4-20 mA,
- Manual override option in case of power failure

DESIGN STANDARDS

- **Design In Accordance** EN593

- **Face To Face Standards** EN558: Series 14 (DIN 3202 F4)

- **Flange End Connections Standards** EN1092-2: PN10 (PN16/PN25/PN40 options are available)

TECHNICAL ADVANTAGES

- DN40 – DN600 Size range available,
- Face to face dimensions according to EN558-1 (series 14) and DIN 3202 (F4)
- 100% watertight sealing performance,
- Full bore design with no zones of retention,
- Suitable for drinking water and neutral liquids up to 70°C,
- Ductile Iron (EN-GJS-500-7) body, bonnet, and wedge,
- EPDM fully vulcanized wedge according to EN681,
- Non-rising AISI 420 stainless steel stem,
- Maintenance-free design with low closing torque,
- PN16 maximum working pressure (PN10 & PN16 drilling options),
- Equipped with edge protection gaskets and dust protection flanges.

SV952 SERIES

FLANGED GATE VALVES



SV680 SERIES

AIR RELEASE VALVES

TECHNICAL ADVANTAGES

- DN50 – DN300 Sizes available,
- Non-slam anti-shock design,
- Hydrostatic tests according EN-12266-1, class A,
- Air Valve for drinking water and neutral liquids up to 80°C,
- Designed to EN-1074/4 and AWWA C-512,
- Flanges to EN-1092/2, ANSI-150,
- Flange drilling acc. PN10, PN16 and PN25 available under request.

Singe Ball Air Valve



Double Ball Air Valve



Combination Air Release Valve



Sewage Combination Air Release Valve



TECHNICAL ADVANTAGES

- DN50 – DN400 Sizes available,
- Face to face dimensions according to EN558 series 48 DIN3202 (F6),
- With counterweight options,
- Flange end connections according to EN1092-2: PN10&PN16,
- Maximum working pressure DN50-DN150 - PN16 / 16 Bar, DN200-DN400 - PN10 / 10 Bar,
- Working temperature 0°C - +80°C,
- Fully vulcanized disc in EPDM,
- Hydraulic test according to EN12266.

SV667 SERIES

FLANGED END SWING CHECK VALVE



SV660 SERIES

THREADED / FLANGED END BALL CHECK VALVE

TECHNICAL ADVANTAGES

- R1" ~ R2½" sizes available for threaded end
DN40 ~ DN400 sizes available for flanged end,
- Design in accordance to EN12050-4,
- Threaded connections according to ISO 228-1,
- Maximum working pressure: PN16 / 16 Bar,
- Working temperature: 0°C - +80°C,
- Powder epoxy coating 250 µm thickness,
- Bonnet gasket in EPDM (NBR option available),



TECHNICAL ADVANTAGES

- DN50 – DN600 Sizes available,
- Compact design,
- Quick removal of lid for maintenance,
- Drain plug enables full drainage without removing the lid,
- Face to face dimensions according to EN558 series 1 and DIN3202 F1,
- Flange end connections according to EN1092-2: PN10&PN16,
- Maximum working pressure: PN10 / 16 Bar,
- Mesh size 1,5mm for DN50-DN150, 3mm for DN200-DN300,
- Working temperature 0°C-80°C,
- Stainless steel bolts,

SV720 SERIES

FLANGED END Y TYPE STRAINER



SV931D SERIES

DISMANTLING JOINT

TECHNICAL ADVANTAGES

- DN50 ~ DN2200 Sizes available,
- Flange end connections according to EN1092-2: PN10/PN16 / PN25 / PN40
- Designed according to EN545
- Maximum working pressure: PN10 / PN16 / PN25 / PN40
- Working temperature: 0°C - +70°C
- Powder epoxy coating 250 µm thickness
- Body from ductile iron EN-GJS-500-7 or steel S235JR epoxy coated
- Bolts, nuts and washers - hot dip galvanized 8.8 carbon steel or stainless steel A2 option available
- Gasket - EPDM. NBR option available





STAR VALVE
STAR VALVE
www.starvalve.com

STAR 3 SERIES ELECTRICAL ACTUATOR
Model STAR 3E
Torque 18 Nm
Power 120 WAC
Act. Type On/Off
Angle 90°
Protection IP67
Current 5 A



CE

STAR VALVE
BODY
DISC
SEAT
TEMP
RATING

ACTUATORS

TECHNICAL ADVANTAGES

- 3 Nm and 13024 Nm torque range,
- As a standard Hard anodized coated aluminum body, PTFE /Nickel/C5 coated options; in corrosive environments suitable for work,
- ISO5211, DIN3337, according to NAMUR standards,
- Double acting and single acting (Normally open/ Normally close) options,
- Suitable for accessories such as mechanical limit switch box, namur type air solenoid valve, positioner, manual override gearbox

STAR-P SERIES

ALUMINUM BODY PNEUMATIC ACTUATORS

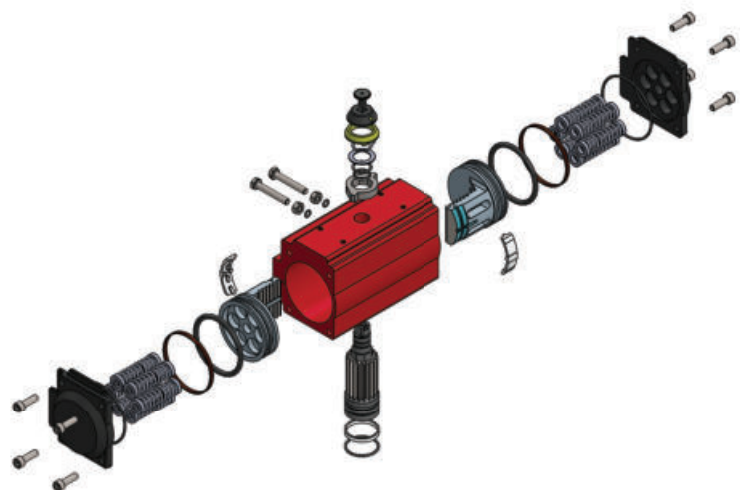

STAR-PP SERIES

POLYAMIDE BODY PNEUMATIC ACTUATORS

TECHNICAL ADVANTAGES

- Glass-fiber-reinforced polyamide body with excellent resistance to corrosion,
- Light in weight and Silicone-free and made with polyamide plus fiberglass offering the best properties,
- ISO5211, DIN3337, according to NAMUR standards,
- Double acting and single acting (Normally open/ Normally close) options,
- Suitable for accessories such as mechanical limit switch box, namur type air solenoid valve, positioner, manual override gearbox



TECHNICAL ADVANTAGES

- High corrosion resistance, long life and mechanical durability in corrosive environments with stainless steel body,
- ISO5211, DIN3337, according to NAMUR standards,
- Double acting and single acting (Normally open/ Normally close) options,
- Suitable for accessories such as mechanical limit switch box, namur type air solenoid valve, positioner, manual override gearbox,
- High temperature resistant material, reliable performance in applications subject to temperature variations

STAR-PS SERIES

STAINLESS STEEL BODY PNEUMATIC ACTUATORS

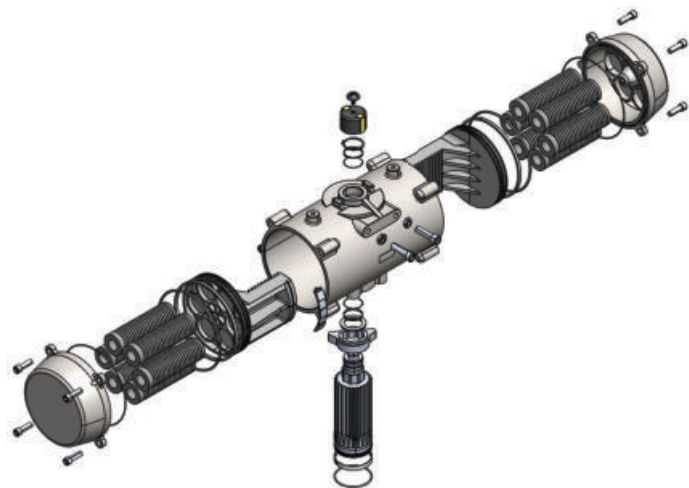

PNEUMATIC ACTUATOR ACCESSORIES

LIMIT SWITCH BOX

- Standard IP67 enclosure,
- 2 pcs Limit Switch with mechanical or proximity,
- 3D On / Off Continuous Position Indicator,
- According to NAMUR Standard all kinds of actuators can be mounting easily,
- 8 Strips on terminal box allows direct connection of solenoid valve inside the switch box,
- Optional Eexd II B T6 ex-proof



THERMOPLASTIC LIMIT SWITCH BOX

- Thermoplastic Body,
- Standard IP67 enclosure,
- 2 Pcs limit switch with mechanical or proximity,
- 3D On / Off continuous position indicator,
- According to namur standard all kinds of actuators can be mounting easily,
- 8 Strips on terminal box allows direct connection of solenoid valve inside the switch box



NAMUR TYPE AIR SOLENOID VALVE

- Standard IP65 enclosure,
- Direct mounting on NAMUR type actuators,
- Lockable manual control,
- Single coil and double coil alternative,
- 5/2, 3/2 and 5/3 working options,
- Optional Eex m II T5 Ex-proof



AIR SOLENOID VALVE

- Standard IP65 enclosure,
- Lockable manual control,
- Single coil and double coil alternative,
- 5/2, 3/2 and 5/3 working options,
- Optional Eex m II T5 Ex-proof



PNEUMATIC ACTUATOR ACCESSORIES

MANUAL CLUTCH TYPE GEARBOX

- 300 Nm – 8.000 Nm torque options,
- 0° – 90° (+/-5°) Mechanical Limit,
- High-strength Steel Output Shaft (Optionally Stainless Steel),
- Ductile Iron Shell (Optionally WCB or Stainless Steel),
- The body is totally sealed, interior is based on the grease to extend service life,
- Designed for direct mounting on butterfly valves, ball valves, plug valves, dampers and flaps,
- IP67 protection rating (Optionally IP68),
- Compatibility with ISO5211 top flange standard for direct valve mounting,
- Gearboxes with precision casting and innovative design

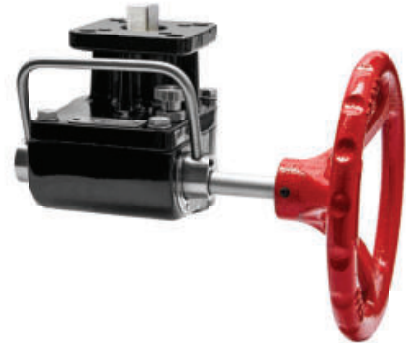

NOVA SERIES THERMOPLASTIC GEAR BOX

- 200 Nm – 8000 Nm torque options,
- 0° – 90° (quarter turn) operating angle,
- 30% Glassfiber reinforced Polyamide (PA6) body material,
- Complies with ISO 5211 standard,
- Proximity or mechanical limit switch box application,
- Open/Closed position indicator,
- Complies with ISO 5211 standard,
- Protection rating IP65 (Optional IP67),
- Operating temperature -10°C – +55°C



POSITIONERS

- Rotary and linear type,
- 3-15 psi pneumatic positioner Input 4-20 mA, 4-20 mA Input / Output (feedback) and (smart),
- Can be applied both on double and single acting pneumatic actuators,
- Ex d II B T6 Ex-proof,
- Aluminum body



VALVE TERMINAL

- Standard IP65 enclosure,
- Lockable manual control,
- Single coil and double coil alternative,
- 5/2, 3/2 and 5/3 working options,
- Optional Ex m II T5 Ex-proof



ALFA SERIES

QUARTER TURN ELECTRICAL ACTUATORS



TECHNICAL ADVANTAGES

- 30 Nm, 50 Nm, 80 Nm, 100 Nm, 140 Nm torque options,
- 0° ~ 90 ° working angle (0° ~ 180 ° , 0° ~ 270 ° , 0° ~ 360 ° on request),
- 220V AC, 24V DC, 24V AC power supply options,
- IP67 protection rating (Optionally IP68),
- Mechanically strong polyamide body fortified with glass fiber,
- Easy opening / closing manually by means of ratcheting wrench in case of power failure,
- Faster opening / closing compared to standard actuators,
- Compatibility with ISO5211 top flange standard for direct valve mounting,
- 100% tightness testing before shipment

TECHNICAL SPECIFICATION

- **Power Supply**
220V AC, 24V DC, 24V AC/DC
- **Motor**
Squirrel Cage Asynchronous Motor
(220V AC, 24V DC, 24V AC/DC, 1ph, Class A, S2 Service)
- **Limit Switches / Auxiliary Limit Switches**
Open / Close 2 x (SPDT 250V AC 10A)
- **Working Angle - Standard (on request)**
0° ~ 90° working angle (0° ~ 180°, 0° ~ 270°, 0° ~ 360° on request)
- **Thermal Protection**
Internal Thermal Protection, Open 120°C ± 5°,
Indoor 97°C ± 5°
- **Position Indicator**
Continuous Position Indicator
- **Manual Control**
Open / Close with Ratcheting Wrench
- **Self Locking**
Position fixing with double gear locking system
when power supply is cut
- **Cable Entry**
2xM16

ALFA-10 SERIES

ELECTRICAL ACTUATORS

TECHNICAL ADVANTAGES

- 10 Nm torque for small equipment,
- Industrial ABS thermoplastic body,
- High-precision metal gear system,
- Real-time monitoring and remote control,
- Standard in Protection Class IP65,
- Manual & Automatic fail-safe options.,
- ISO5211 standard for direct mounting,
- 2-3 way valve compatibility up to 2",

TECHNICAL SPECIFICATION

- **Power Supply**
9-36V DC ~110-230V AC
- **Operating Temperature**
-20°C to +60°C
- **Open/Close Time**
5 - 12 seconds
- **Protection Rating**
IP65
- **Control Signal**
On/Off
- **Dimensions**
66mm x 86mm x 89mm
- **Manual Control**
Open/close operation via hex (Allen) key
in case of power failure
- **Options**
Capacitor for emergency operation
during power outage



STAR-E SERIES

QUARTER TURN ELECTRICAL ACTUATORS



TECHNICAL ADVANTAGES

- 30 Nm and 6.000 Nm torque range,
- 0° – between 270° work facilities ,
- 24V DC, 110V DC, 110V AC, 220V AC, 380V AC supply options,
- 4-20 mA or with 0-10V proportional control facilities, Standard in Protection Class IP67, optional IP68 protection class,
- Standard open/close mechanical limit switch,
- When power cut off with an allen open / close,
- Local control unit, potentiometer options,
- Super fast open/close options (2.5s, 5s, 10s, 15s),
- Powder coated aluminum injection body,
- ISO5211 standardization

TECHNICAL SPECIFICATION

- **Actuator Supply**
Standard: 220V AC
- **Optional**
24V DC, 220V DC, 110V AC, 380V AC, 440V AC
- **Motor**
Induction Motor
- **Limit Switches**
Open / Close 2 pcs (SPDT 250V AC 10A)
- **Working Angle**
90°~ 270° ±10°
- **Thermal Protection**
Internal Thermal Protection, Open 120°C ± 5°,
close 97°C ± 5°
- **Position Indicator**
Continuous Position Indicator
- **Manual Control**
With an allen open-close
- **Self Locking**
When the power is cut with double gear
system locking position
- **Mechanical Stops**
Separately adjustable opening and closing
direction bolled stops
- **Heater**
Anti - condensing heater
- **Cable Entry**
2xM20*1.5

TECHNICAL ADVANTAGES

- 50 Nm and 5,000 Nm torque range,
- 0° between 90° work facilities,
- 24V DC, 110V AC, 220V AC, 380V AC supply options,
- 4-20 mA or 0-10V proportional control facilities,
- Standard in Protection Class IP67, Optional IP68 protection class,
- Standard Open/Close mechanical limit switch,
- When power cut off with manual override open / close,
- Local control unit, potentiometer options,
- Powder coated aluminum injection body,
- ISO5211 standardization,
- Ex-proof (Exd II C T5) option

TECHNICAL SPECIFICATION

- **Actuator Supply**
Standard: 220V AC
- **Optional**
24V DC, 110V AC, 380V AC, 440V AC
- **Control Signal**
110V AC / 220V AC 1 phase, 50/60Gz, ± 10
- **Motor**
Induction Motor
- **Limit Switches**
Open / Close 2 psc (SPDT 250V AC 10A)
- **Torque Switches**
Open/Close 1 pcs (SPDT 25V AC 10A) (available STAR-EV 150 and up)
- **Working Angle**
 $90^\circ \pm 10^\circ$
- **Thermal Protection**
Internal Thermal Protection, Open $120^\circ\text{C} \pm 5^\circ$, Close $97^\circ\text{C} \pm 5^\circ$
- **Position Indicator**
Continuous Position Indicator
- **Manual Control**
With Manual Override
- **Self Locking**
When the power is cut with double gear system locking position
- **Mechanical Stops**
Separately adjustable opening and closing direction bolted stops
- **Heater**
Anti-condensing heater
- **Cable Entry**
 $2 \times \frac{3}{4}''$

STAR-EV SERIES

QUARTER TURN ELECTRICAL ACTUATORS WITH MANUAL OVERRIDE



STAR-M SERIES

MULTITURN ELECTRICAL ACTUATORS



TECHNICAL ADVANTAGES

- 70 Nm ~ 1.000 Nm torque options,
With gearbox 1.000Nm ~ 500.000Nm,
- 110V AC, 220V AC, 380V AC, 440V AC supply options,
- 4-20 mA Proportional Control Facilities,
- Standard in Protection Class IP67
Optional IP68 Protection Class,
- When power cut off with manual override open/close,
- Local Control Units option,
- Ex-proof (Exd II CT4) option

TECHNICAL SPECIFICATION

- **Actuator Supply**
Standard: 380V AC/3ph
Optional: 110/220V AC/1ph, 440V AC/3ph, 50/60Hz, $\pm 10\%$
- **Motor**
Asynchronous Motor
- **Limit Switches**
1xOpen/Close, SPDT 250V AC 10A (on/off model)
- **Auxiliary Limit Switches**
1xOpen/Close, SPDT 250V AC 10A (on/off model)
- **Torque Switches**
1xOpen/Close, SPDT 250V AC 10A
- **Operating Temperature**
Internal-placed thermal protection, Open 120°C $\pm 5^\circ\text{C}$ / Close 97°C $\pm 5^\circ\text{C}$
- **Manual Operation**
Declutching mechanism, with handwheel operation
- **Self Locking Device**
Self locking by worm and worm gear
- **Space Heater**
30w (110/220V AC) Condensation preventing
(according to conditions, can be adjusted)
- **Conduit Entry**
Double seal 3x (PT $\frac{3}{4}$ ", PT1 $\frac{1}{2}$ ", PT1 optional)
- **Ambient Temperature**
-25°C ~ 7°C (-30°C, -40°C, -60°C optional)
- **Lubrication**
Special oil for 00 actuators
- **Material**
Ductile iron, high strength aluminum alloys steel
- **External Coating**
Dry power, epoxy polyethylene high anti-corrosion
- **Overload Protection**
Torque top overload protection
- **Display Screen**
LED display (smart regulation type)
- **Setting Mode**
Non-intrusive setting (Without opening the cover set type)
- **Electrically**
Integrated control unit with a non-invasive rotary switch

MEASURING AND CONTROL EQUIPMENT

SV810 SERIES

VARIABLE AREA FLOWMETERS

TECHNICAL ADVANTAGES

- R½" ~ R6" (DN15 ~ DN150) Sizes,
- Wide choice of measuring scales,
- SS and PP float materials,
- Suitable for line type vertical mounting,
- Drinking water standards,
- CaCO₃ (Calcite) free 100% pure virgin material,
- UV resistant power added,
- Specially designed for heavy industrial applications,
- Water Applications EPDM O-Ring, Acidic Applications Viton O-Ring alternatives,
- Working pressure max: 6 Bar



CONTROL OPTIONS

- Flanged (U-PVC, C-PVC, PP-H, PVDF),
- Socket Solvent Cement (U-PVC, C-PVC),
- Socket Welded (PP-H, PVDF)

APPLICATION AREA

- Chemical and Petrochemical Industry,
- Water and Process Technologies,
- Shipbuilding and Yacht Industry,
- Electrolysis Premises,
- Mining Industry,
- Food Industry,
- Cooling Systems,
- Coating Plant

TECHNICAL ADVANTAGES

- R $\frac{1}{4}$ " ~ R1" (DN8 ~ DN25) Sizes,
- U-PVC / C-PVC / PP-H / PVDF / SS304 / SS316 Body material,
- PTFE Diaphragm material,
- Specially designed for heavy industrial applications,
- working pressure max: 10 Bar

SV815 SERIES

DIAPHRAGM TYPE PRESSURE GAUGE



CONNECTION TYPE

- Threaded (U-PVC, C-PVC, PP-H, PVDF)

APPLICATION AREA

- Chemical and Petrochemical Industry,
- Water and Process Technologies,
- Shipbuilding and Yacht Industry,
- Electrolysis Premises,
- Mining Industry,
- Food Industry,
- Cooling Systems,
- Coating Plant

SV819 SERIES

PULSATION DAMPENERS

TECHNICAL ADVANTAGES

- R $\frac{1}{2}$ " - R6" (DN15 - DN150) Sizes,
- EPDM, NBR, or PTFE diaphragm options,
- Body material options PVC, PVDF, SS316, SS304
- Working pressure maximum operating pressure of 16 bar,
- Connection standards compatible with ISO 228/1 or G1/4 connection standards,
- Performance effectively reduces pipeline vibrations and water hammer effects caused by various pumps,
- Functional Design acts as a vibration dampener, anti-vibrator, or surge tank to balance system fluctuations,
- Volume options 0.35-4 liters



FEATURES

- Connection Types: Internal threaded connections available in 1/2", 3/4", 1", 1 1/4", 1 1/2", and 2".
- Standard Compliance: Threaded connections designed according to ISO 228/1 standards

APPLICATION AREA

- Metering Systems,
- Pump Compatibility,
- Industrial Pipelines,
- System Protection



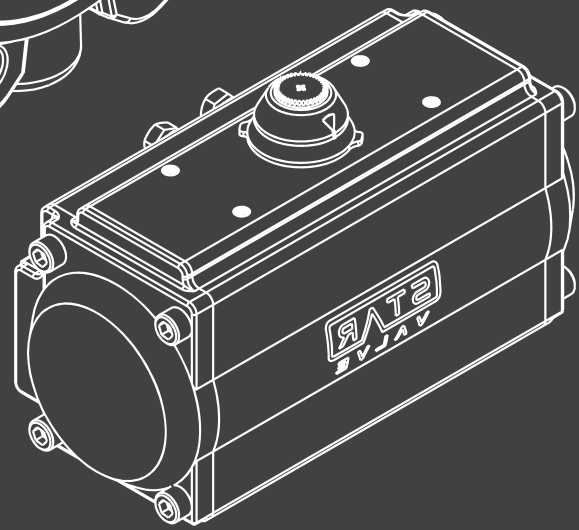
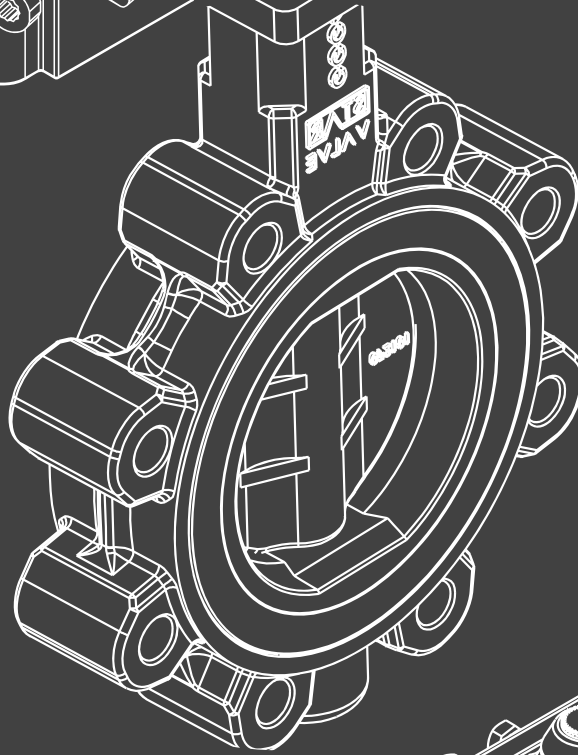
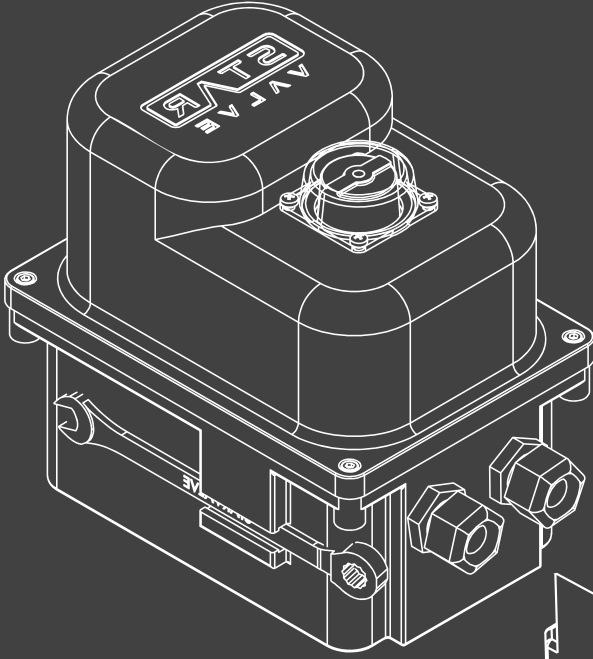

**Starvalve Proses Vanaları
ve Aktüatör Teknolojisi San. Ve Tic. A.Ş.**

Kocaeli Kobi OSB, Köşeler Mah. 3. Cad. No: 3
Dilovası / KOCAELİ / TÜRKİYE

Tel: +90 216 593 20 33
Fax: +90 216 593 20 34

info@starvalve.com.tr
www.starvalve.com.tr